

Nine Fine imported motors from Europe

- CE
- IEC squirrel-cage high-efficiency induction motor
- Compliant with the latest international standards for high-efficiency motors
- A full line of models featuring IP55
- Class F insulation; Class B temperature rise

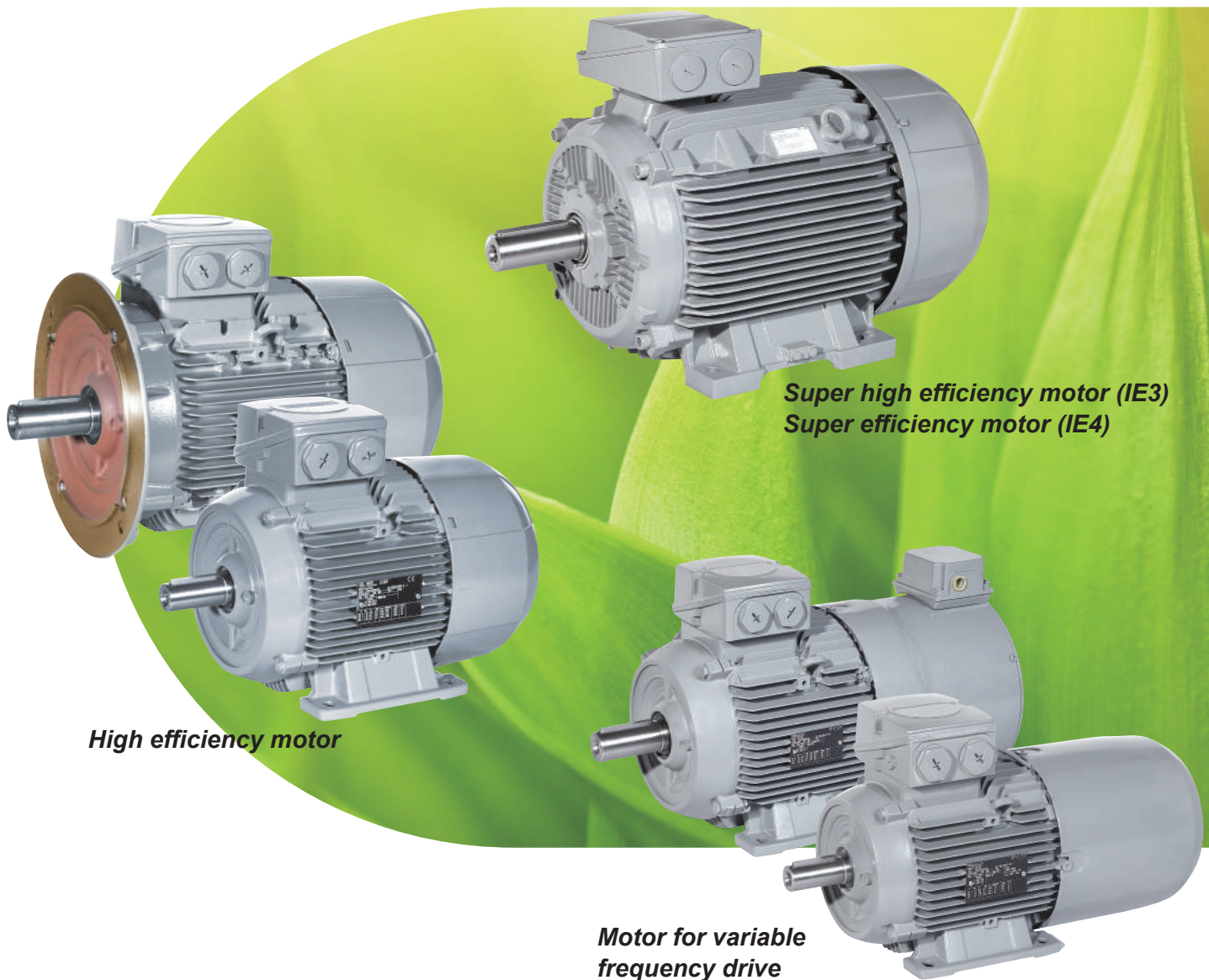

NineFine

High quality motor representative
Imported motor from Europe

The Company has been well received in the manufacturing and electronics industry for its excellent quality and positive service attitude. In order to improve the international competitiveness of the domestic industry and to demonstrate a responsible attitude towards our products, we have introduced new energy efficient motors IE1 and IE3 that meet international standards. We have completed a contract with Siemens Group to manufacture Nine Fine high quality motors on an ODM basis in order to provide higher quality and service to our customers.

High market specifications; excellent quality

Compared to the market's common SF1.0, IP54, Class E insulation (120°C), Class F allowable temperature rise (below 100°C)

Nine Fine uses SF1.15, IP55, and Class F insulation (155°C) for all models

The highest specification of Class B temperature rise (below 80°C) and the frame size 112 above specified use of 63 series bearings, excellent quality is readily available.

Pure German products imported from Europe

Nowadays, the motor market is complicated and filled with poor quality assembled products. The Company insists on honesty and only provides customers with high-quality, original motors imported from Germany, with good quality and original labels.

It is our responsibility to make you satisfied

Making customers satisfied is the driving force of the Company's progress. Our business philosophy is stable quality, short delivery time, professional technology, and comprehensive after-sales service. Over the years, Customer satisfaction is as high as 98%, and the general impression is: [1. Good motor performance; 2. variety; 3. reliable quality]. The quality of the products is guaranteed and customers can choose with confidence.

Respond to Green Energy Policy

With the global climate change, the demand for housing has increased, and countries have been making efforts to save energy and reduce emissions. In order to control the global warming caused by carbon dioxide emissions, the government fully promotes the use of high-efficiency motors, and any domestic or imported equipment must be equipped with the motor.

1TZ9 series high-efficiency motor is available worldwide

The following two product lines are supplied according to the efficiency needs of each country.

1TZ9002/9502	IE1	1TZ9003/9503	IE3
Meet the EU efficiency specification IE1 level, no high requirements can be used.		Compliant with EU efficiency specification IE3 level, the model's quality is the same as the IE2 motor. Additionally, it is the best choice for enterprises to save costs because of its high efficiency and energy saving.	

1TZ series product models

- Motor type: Squirrel-cage high-efficiency induction motor.
- Output: 0.18 - 500KW Frame size: 60 – 355 Number of poles: 2, 4, 6, 8 poles.
- Material: 80 - 160 aluminum frame. 180 - 355 feature iron frame.
- Protected type: IP 55, Class F Insulation, Class B temperature rise, Totally
- Enclosed Fan-Cooled.

1TZ series product features

- 4x90° steering type junction box, convenient for wire out in any direction.
- Double bolt design, more convenient to disassemble and install the junction box.
- Four lifting rings of 4x90°, the motor moves more smoothly.
- Snap-In fan housing, tool-free disassembly, and time-saving and convenient installation.
- 63 series bearings specially used for frame size 112 or above.

1TZ series encoding principle

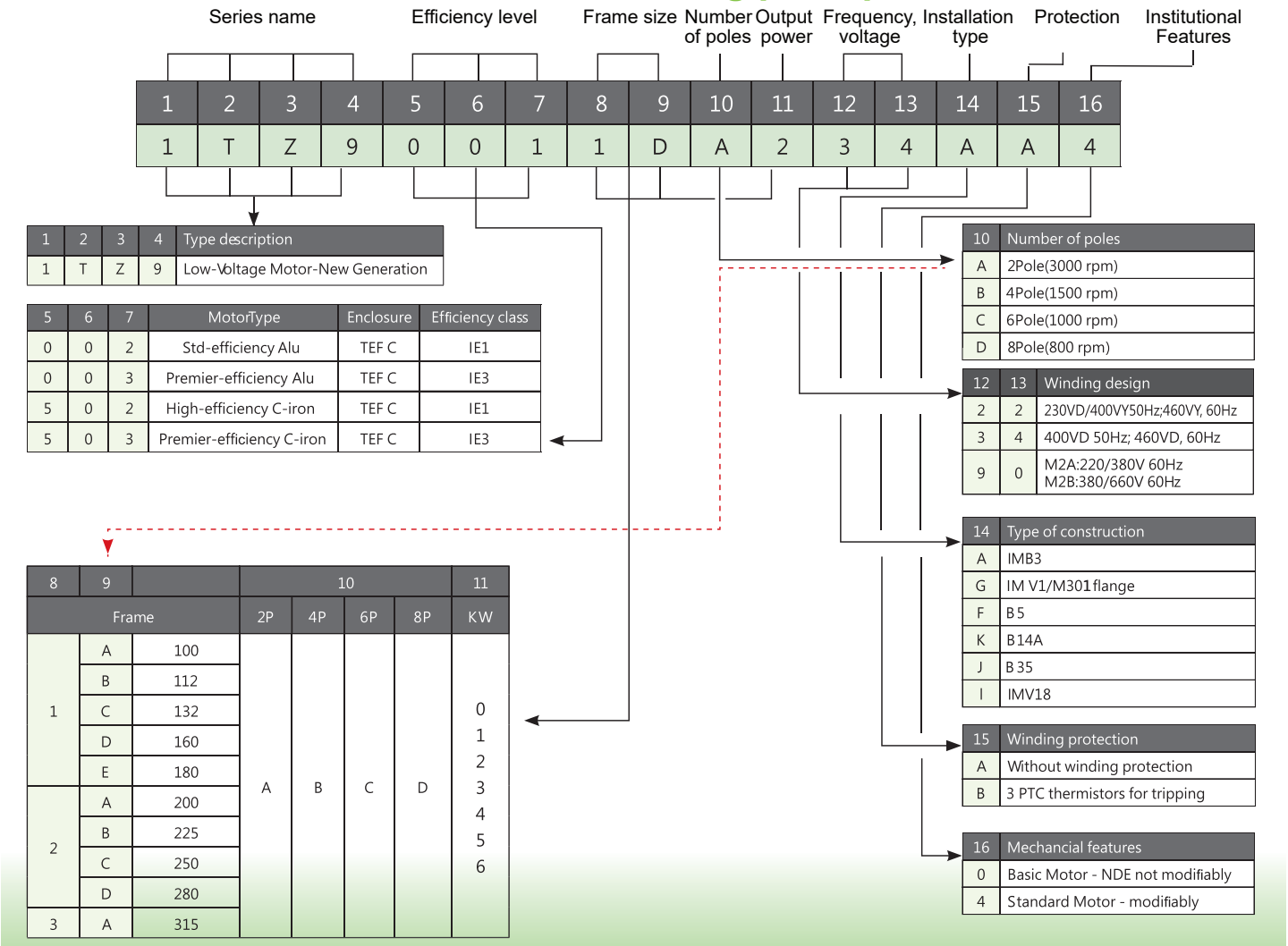

Nine Fine Original imported motor from Europe

IE4/ 50Hz

Totally Enclosed Fan-Cooled type, IP55
Class F insulation, Class B temperature rise, continuous rating S1

Type	Model number	Output		P	Full load revolution speed rpm	Full load efficiency %	Full load power factor %	Full load current A			Starting current	Torsional moment			Moment of inertia Kgm2	Alum-inum weight /B3 Kg	Iron weight /B3 Kg	
		KW	HP					380V	400V	415V		Full load torsional moment NM	Starting torsional moment %	Maximum torsional moment %				
1TZ9004-1AB4	100L	2.2	3	4	1465	89.5	79	4.7	4.5	4.3	8.5	14	330	470	0.014	30	41	
1TZ9004-1AA4	100L	3	4	2	2920	89.1	86	6.0	5.7	5.5	9.0	9.8	370	490	0.0054	27	38	
1TZ9004-1AB5	100L			4	4	1460	90.4	81	6.2	5.9	5.7	8.8	20	350	420	0.016	38	50
1TZ9004-1BA2	112M	4	5.5	2	2950	90.0	89	7.6	7.2	6.9	8.8	13	260	410	0.012	34	45	
1TZ9004-1BB2	112M			4	4	1465	91.1	81	8.2	7.8	7.5	8.3	26	310	430	0.02	46	58
1TZ9004-1CA0	132S	5.5	7.5	2	2960	90.9	84	11.0	10.4	10.0	8.6	18	210	460	0.024	44	62	
1TZ9004-1CB0	132S			4	4	1470	91.9	83	11.0	10.4	10.0	8.3	36	260	350	0.039	59	77
1TZ9004-1CA1	132S	7.5	10	2	2955	91.7	91	13.7	13.0	12.5	8.6	24	220	430	0.031	56	74	
1TZ9004-1CB2	132M			4	4	1470	92.6	0.81	15.2	14.4	13.9	7.7	49	300	400	0.046	62	80
1TZ9004-1DA2	160M	11	15	2	2955	92.6	90	20.1	19.1	18.4	8.6	36	280	420	0.061	84	113	
1TZ9004-1DB2	160M			4	4	1475	93.3	82	22.1	21.0	20.2	8.1	71	290	410	0.099	98	127
1TZ9004-1DA3	160M	15	20	2	2955	93.3	90	27.4	26.0	25.1	9.0	48	310	450	0.068	98	130	
1TZ9004-1DB4	160L			4	4	1480	93.9	80	30.5	29.0	28.0	7.8	97	370	430	0.11	109	138
1TZ9004-1DA4	160L	18.5	25	2	2955	93.7	91	33.2	31.5	30.4	8.9	60	310	430	0.074	112	147	
1TZ9504-1EB2	180M			4	4	1470	94.2	81	36.8	35.0	33.7	7.9	120	270	360	0.17	153	187
1TZ9504-1EA2	180M	22	30	2	2950	94	89	40.0	38	36.6	8.9	71	280	430	0.091	139	175	
1TZ9504-1EB4	180L			4	4	1475	94.5	81	43.7	41.5	40.0	7.7	142	290	380	0.18	158	192
1TZ9504-2AA4	200L	30	40	2	2955	94.5	83	56.8	54.0	52.1	7.9	97	280	400	0.13	173	222	
1TZ9504-2AB5	200L			4	4	1475	94.9	81	59.0	56.0	54.0	7.3	194	320	360	0.27	205	258
1TZ9504-2AA5	200L	37	50	2	2955	94.8	88	67.4	64.0	61.7	7.8	120	290	400	0.2	214	263	
1TZ9504-2BB0	225S			4	4	1485	95.2	84	70.5	67.0	64.6	8.4	238	320	320	0.52	-	345
1TZ9504-2BA2	225M	45	60	2	2970	95.0	85	84.2	80.0	77.1	8.8	145	310	410	0.26	-	330	
1TZ9504-2BB2	225M			4	4	1485	95.4	84	85.3	81.0	78.1	8.0	289	340	330	0.66	-	415
1TZ9504-2CA2	250M	55	75	2	2978	95.3	88	100	95.0	91.6	7.5	176	250	320	0.48	-	430	
1TZ9504-2CB2	250M			4	4	1486	95.7	86	101	96.0	92.5	8.2	353	300	330	1.1	-	490
1TZ9504-2DA0	280S	75	100	2	2980	95.6	89	134	127	122	8.4	240	270	350	0.94	-	610	
1TZ9504-2DB0	280S			4	4	1490	96.0	85	140	133	128	9.2	481	340	380	1.7	-	670
1TZ9504-2DA2	280M	90	125	2	2978	95.8	89	160	152	147	8.4	289	270	350	1.0	-	610	
1TZ9504-2DB2	280M			4	4	1488	96.1	86	165	157	151	9.0	578	320	340	2.0	-	730
1TZ9504-3AA0	315S	110	150	2	2985	96.0	89	196	186	179	8.8	352	260	340	1.4	-	750	
1TZ9504-3AB0	315M			4	4	1491	96.3	86	202	192	185	8.6	705	320	330	2.7	-	910
1TZ9504-3AA2	315M	132	175	2	2988	96.2	90	232	220	212	10.5	422	310	400	1.9	-	980	
1TZ9504-3AB2	315M			4	4	1491	96.4	87	237	225	217	8.7	845	330	330	3.1	-	990
1TZ9504-3AA4	315L	160	215	2	2988	96.3	92	274	260	251	10.3	511	320	390	2.1	-	1060	
1TZ9504-3AB4	315L			4	4	1490	96.6	86	295	280	270	9.0	1025	360	320	3.7	-	1180
1TZ5504-3AD7	315L			8	8	741	95.1	79	321	305	294	6.3	2062	250	250	6.78	-	1420
1TZ9504-3AA5	315L	200	270	2	2986	96.5	92	342	325	313	10	640	350	390	2.4	-	1180	
1TZ9504-3AB5	315L			4	4	1490	96.7	86	363	345	333	9.2	1282	380	340	4.4	-	1300
1TZ5504-3AC7	315L			6	6	992	96.3	82	384	365	352	7.5	1925	300	320	6.28	-	1410
1TZ5504-3AD8	315L			8	8	742	95.4	78	411	390	376	6.7	2574	270	290	8.6	-	1660
1TZ5504-3AA6	315L	250	335	2	2986	96.5	88	447	425	410	9.3	800	300	420	2.82	-	1340	
1TZ5504-3AB6	315L			4	4	1490	96.7	86	458	435	419	7.9	1602	280	320	4.98	-	1500
1TZ5504-3AC8	315L			6	6	992	96.5	81	484	460	443	8.2	2407	320	330	8.00	-	1700
1TZ5604-3BD1	355L			8	8	744	95.4	80	500	475	458	7.1	3209	240	270	13.30	-	2280
1TZ5504-3AA7	315L	315	420	2	2986	96.5	87	568	540	521	9.9	1007	350	420	3.27	-	1520	
1TZ5504-3AB7	315L			4	4	1490	96.7	83	600	570	549	8.5	2019	320	350	5.39	-	1560
1TZ5604-3BC2	355M			6	6	993	96.6	82	600	570	549	7.8	3029	290	320	11.6	-	2040
1TZ5604-3BD2	355L			8	8	744	95.4	80	632	600	578	7.3	4043	250	300	14.0	-	2310
1TZ5604-3BA3	355M	355	475	2	2988	96.5	89	632	600	578	8.9	1135	260	400	4.74	-	2100	
1TZ5604-3BB3	355M			4	4	1492	96.7	83	674	640	617	7.9	2272	280	280	6.76	-	2050
1TZ5604-3BC3	355M			6	6	993	96.6	83	674	640	617	8.4	3414	290	330	13.7	-	2250
1TZ5604-3BA4	355L	400	535	2	2986	96.5	92	684	650	627	8.5	1279	260	340	5.36	-	2240	
1TZ5604-3BB4	355L			4	4	1492	96.7	82	768	730	704	7.9	2560	320	290	7.16	-	2080
1TZ5604-3BC4	355L			6	6	993	96.6	84	747	710	684	8.1	3847	280	300	13.4	-	2240
1TZ5604-3BA5	355L	500	670	2	2988	96.5	89	884	840	810	8.9	1598	300	380	5.76	-	2340	
1TZ5604-3BB5	355L			4	4	1491	96.7	86	916	870	839	8.1	3202	310	330	8.36	-	2290

Note :

The above type number 1TZ90 has a cast aluminum casing. 1TZ95/1TZ55/1TZ56 feature a cast iron casing. If you want specific materials other than those stated above, please replace your model.

IE4/60Hz *Totally Enclosed Fan-Cooled type, IP55*
Class F insulation, Class B temperature rise, continuous rating S1

Type	Model number	Output			P	Full load revolution speed rpm	Full load efficiency %	Full load power factor %	Full load current A			Starting current	Torsional moment			Moment of inertia Kgm2	Alum-inum weight /B3 Kg	Iron weight /B3 Kg
		KW	HP						220V	380V	460V		Full load torsional moment NM	Starting torsional moment %	Maximum torsional moment %			
1TZ9004-1AB4	100L	2.2	3	4	1770	91.0	77	8.2	4.75	3.9	9.9	12	390	550	0.014	30	41	
1TZ9004-1AA4	100L	3	4	2	3530	89.5	85	10.3	6.0	4.95	10.8	8.1	470	600	0.0054	27	38	
1TZ9004-1AB5	100L			4	1765	91.0	80	10.8	6.3	5.2	10.1	16.2	410	500	0.016	38	50	
1TZ9004-1BA2	112M	.7	5.5	2	3560	89.5	88	12.3	7.1	5.9	11.0	9.9	330	510	0.012	34	45	
1TZ9004-1BB2	112M	4	5.5	4	1770	91.0	78	13.7	7.9	6.5	10.0	20	370	540	0.02	46	58	
1TZ9004-1CA0	132S	5.5	7.5	2	3565	90.2	83	19.3	11.2	9.2	9.9	14.7	230	550	0.024	44	62	
1TZ9004-1CB0	132S	5.5	7.5	4	1770	92.4	82	19.0	11.0	9.1	9.4	29.5	290	410	0.034	59	77	
1TZ9004-1CA1	132S	.5	10	2	3560	91.7	90	24.0	13.8	11.4	10.0	20	280	500	0.031	56	74	
1TZ9004-1CB2	132M	7.5	10	4	1775	92.4	80	26.5	15.4	12.7	8.8	40.5	340	450	0.046	62	80	
1TZ9004-1DA2	160M	11	15	2	3560	92.4	89	35.0	20.5	16.8	9.8	29.5	330	480	0.061	84	113	
1TZ9004-1DB2	160M	11	15	4	1785	93.6	81	38.0	22.0	18.2	9.0	59	330	450	0.085	98	127	
1TZ9004-1DA3	160M	15	20	2	3560	92.4	89	48.0	27.5	23.0	10.0	40	350	500	0.068	98	130	
1TZ9004-1DB4	160L	15	20	4	1780	94.1	79	53.0	30.5	25.5	8.8	80	390	480	0.099	109	138	
1TZ9004-1DA4	160L	18.5	5	2	3560	93.0	90	58.0	33.5	27.5	10.1	49.5	350	490	0.073	112	147	
1TZ9504-1EB2	180M	18.5	25	4	1775	94.5	80	64.0	37.0	30.5	9.0	100	290	400	0.17	153	187	
1TZ9504-1EA2	180M	2	30	2	3560	93.0	88	71.0	41.0	33.5	9.8	59	320	470	0.091	139	175	
1TZ9504-1EB4	180L			4	1778	94.5	79	77.0	45.0	37.0	8.9	118	310	430	0.18	158	192	
1TZ9504-2AA4	200L	30	40	2	3565	93.6	84	100.0	58.0	48.0	8.7	80	310	420	0.14	173	222	
1TZ9504-2AB5	200L			4	1780	95.0	80	104.0	60.0	49.5	8.4	161	350	400	0.27	205	258	
1TZ9504-2AA5	200L	37	50	2	3560	94.1	87	119.0	69.0	57.0	9.0	99	370	420	0.19	214	263	
1TZ9504-2BB0	225S	7	50	4	1786	95.4	83	123.0	71.0	59.0	9.8	198	360	360	0.52	-	345	
1TZ9504-2BA2	225M	45	60	2	3575	94.5	85	147.0	85.0	70.0	9.8	120	350	460	0.26	-	330	
1TZ9504-2BB2	225M			4	1786	95.4	83	149.0	86.0	71.0	9.3	240	390	370	0.66	-	415	
1TZ9504-2CA2	250M	55	75	2	3580	94.5	88	174	100	83.0	8.7	147	280	350	0.48	-	430	
1TZ9504-2CB2	250M	55	75	4	1788	95.8	85	177	103	85.0	9.3	295	330	370	1.1	-	490	
1TZ9504-2DA0	280S	75	100	2	3582	95.0	89	235	135	111	9.5	200	330	370	0.94	-	600	
1TZ9504-2DB0	280S	75	100	4	1791	96.2	84	245	141	116	10.3	400	400	420	1.7	-	670	
1TZ9504-2DA2	280M	90	125	2	3580	95.4	89	280	161	133	9.5	240	330	370	1.0	-	610	
1TZ9504-2DB2	280M	90	125	4	1788	96.2	86	285	165	137	9.5	480	350	370	2.0	-	730	
1TZ9504-3AA0	315S	110	150	2	3586	95.4	89	340	197	163	9.5	295	290	380	1.4	-	750	
1TZ9504-3AB0	315M	110	150	4	1792	96.2	85	355	205	169	9.6	590	360	360	2.7	-	910	
1TZ9504-3AA2	315M	132	175	2	3590	95.8	89	405	235	194	11.8	350	330	430	1.9	-	980	
1TZ9504-3AB2	315M			4	1792	96.5	86	415	240	200	9.9	700	400	370	3.1	-	990	
1TZ9504-3AA4	315L	160	215	2	3588	95.8	91	480	280	230	12.0	425	410	420	2.1	-	1060	
1TZ9504-3AB4	315L			4	1792	96.5	86	510	295	240	10.0	850	410	360	3.7	-	1220	
1TZ5504-3AD7	315L			8	893	95.4	79	-	325	265	7.2	1711	290	280	6.78	-	1420	
1TZ9504-3AA5	315L	200	270	2	3588	96.2	91	600	345	320	11	530	400	400	2.4	-	1180	
1TZ9504-3AB5	315L			4	1792	96.5	86	630	365	300	10.5	1070	440	380	4.4	-	1380	
1TZ5504-3AC7	315L			6	1194	96.2	81	-	390	320	9.0	1600	320	350	6.28	-	1410	
1TZ5504-3AD8	315L			8	893	95.4	77	-	415	340	7.5	2139	320	320	8.6	-	1660	
1TZ5504-3AA6	315L	250	335	2	3588	96.2	88	-	450	370	11.0	665	410	460	2.82	-	1340	
1TZ5504-3AB6	315L			4	1791	96.8	85	-	460	380	8.7	1330	330	350	4.98	-	1500	
1TZ5504-3AC8	315L			6	1194	96.5	81	-	485	400	9.5	1999	360	370	8.00	-	1700	
1TZ5604-3BD1	355L			8	895	95.8	78	-	510	420	8.3	2667	260	300	13.30	-	2280	
1TZ5504-3AA7	315L	315	420	2	3588	96.2	87	-	570	470	11	838	410	460	3.27	-	1520	
1TZ5504-3AB7	315L			4	1792	96.8	83	-	600	490	9.4	1679	340	370	5.39	-	1560	
1TZ5604-3BC2	355M			6	1194	96.5	82	-	600	500	9.2	2519	320	360	11.60	-	2040	
1TZ5604-3BD2	355L			8	895	95.8	78	-	640	530	8.6	3361	270	320	14.0	-	2310	
1TZ5604-3BA3	355M	355	475	2	3590	96.2	89	-	630	520	9.5	944	260	450	4.74	-	2100	
1TZ5604-3BB3	355M			4	1793	96.8	84	-	660	550	9.0	1891	350	310	6.76	-	2050	
1TZ5604-3BC3	355M			6	1194	96.5	86	-	680	560	9.4	2839	320	370	13.7	-	2250	
1TZ5604-3BA4	355L	400	535	2	3590	96.2	91	-	690	570	9.8	1064	330	400	5.4	-	2240	
1TZ5604-3BB4	355L			4	1794	96.8	81	-	780	640	9.5	2129	380	320	7.16	-	2080	
1TZ5604-3BC4	355L			6	1194	96.5	84	-	750	620	9.3	3199	320	330	13.4	-	2240	
1TZ5604-3BA5	355L	500	670	2	3590	96.2	89	-	890	730	10	1330	340	440	5.76	-	2340	
1TZ5604-3BB5	355L			4	1792	96.8	86	-	910	750	9.5	2664	350	370	8.36	-	2290	

Note :
 The above type number 1TZ90 has a cast aluminum casing. 1TZ95/1TZ55/1TZ56 feature a cast iron casing. If you want specific materials other than those stated above, please replace your model.

IE3 / 50Hz

Totally Enclosed Fan-Cooled type, IP55
Class F insulation, Class B temperature rise, continuous rating S1

Type	Model number	Output		P	Full load revolution speed rpm	Full load efficiency %	Full load power factor %	Full load current A			Starting current	Torsional moment			Moment of inertia Kgm2	Aluminum weight /B3 Kg	Iron weight /B3 Kg
		KW	HP					380V	400V	415V		Full load torsional moment NM	Starting torsional moment %	Maximum torsional moment %			
1TZ9503-0CC2	71M	0.18	1/4	6	885	63.9	69	0.62	0.59	0.57	2.8	1.9	230	230	0.001	-	13
1TZ9503-0CB2	71M	0.25	1/3	4	1395	73.5	72	0.72	0.68	0.66	4.2	1.7	250	260	0.00095	-	13
1TZ9503-0CC3	71M			6	885	68.6	69	0.8	0.76	0.73	3.2	2.7	260	260	0.0015	-	16
1TZ9503-0CB3	71M	0.37	1/2	4	1410	77.3	70	1.04	0.99	0.95	4.8	2.5	310	310	0.0014	-	16
1TZ9003-0DC2	80M			6	940	73.5	66	1.16	1.1	1.06	4.2	3.8	230	270	0.0025	12	19
1TZ9003-0DB2	80M	0.55	3/4	4	1440	80.8	78	1.33	1.26	1.21	5.9	3.6	210	310	0.0021	11	18
1TZ9003-0DC3	80M			6	935	77.2	67	1.61	1.53	1.47	4.5	5.6	250	280	0.0031	14	22
1TZ9003-0DA2	80M	0.75	1	2	2850	80.7	86	1.64	1.56	1.5	6.2	2.5	260	300	0.0011	11	18
1TZ9003-0DB3	80M			4	1450	82.5	75	1.84	1.75	1.69	7.1	4.9	270	390	0.0029	14	22
1TZ9003-0EC0	90S			6	945	78.9	70	2.06	1.96	1.89	4.6	7.6	220	260	0.004	16	26
1TZ9003-0DA3	80M	1.1	1.5	2	2885	82.7	85	2.37	2.25	2.17	7.1	3.6	300	330	0.0013	12	21
1TZ9003-0EB0	90S			4	1440	84.1	78	2.53	2.4	2.31	6.9	7.3	290	360	0.0036	16	25
1TZ9003-0EC4	90L			6	940	81	69	3	2.85	2.75	4.6	11	230	270	0.0048	19	32
1TZ9003-0EA0	90S	1.5	2	2	2910	84.2	86	3.16	3	2.89	8.1	4.9	270	420	0.0021	15	26
1TZ9003-0EB4	90L			4	1445	85.3	80	3.32	3.15	3.04	7.3	9.9	290	350	0.0049	19	31
1TZ9003-1AC4	100L			6	970	82.5	73	3.79	3.6	3.47	5.2	15	190	280	0.011	25	36
1TZ9003-0EA4	90L	2.2	3	2	2910	85.9	88	4.42	4.2	4.05	8.3	7.2	260	400	0.0031	19	32
1TZ9003-1AB4	100L			4	1465	86.7	83	4.63	4.4	4.24	7.6	14.3	210	360	0.014	30	40
1TZ9003-1BC2	112M			6	970	84.3	75	5.26	5	4.82	5.6	22	220	280	0.017	34	53
1TZ9003-1AA4	100L	3	4	2	2920	87.1	88	5.89	5.6	5.4	8.1	9.8	320	460	0.0054	26	36
1TZ9003-1AB5	100L			4	1460	87.7	83	6.21	5.9	5.69	7.3	20	230	370	0.014	30	40
1TZ9003-1CC0	132S			6	975	85.6	73	6.95	6.9	6.36	6.6	29	230	320	0.034	42	60
1TZ9003-1BA2	112M	4	5.5	2	2950	88.1	89	7.68	7.4	7.04	8.7	13	250	400	0.012	34	45
1TZ9003-1BB2	112M			4	1460	88.6	82	8.32	7.9	7.61	7.1	26	240	370	0.017	34	46
1TZ9003-1CC2	132SM			6	975	86.8	73	9.05	9.1	8.29	6.2	9	220	300	0.039	46	64
1TZ9003-1CA0	132S	5.5	7.5	2	2950	89.2	90	10.4	9.9	9.54	7.3	18	190	370	0.024	43	58
1TZ9003-1CB0	132S			4	1470	89.6	84	11.1	10.5	10.1	7.2	36	210	340	0.046	64	74
1TZ9003-1CC3	132M			6	975	88	72	12.3	12.5	11.3	6.8	54	270	340	0.05	58	76
1TZ9003-1CA1	132S	7.5	10	2	2950	90.1	92	13.8	13.1	12.6	8.3	24.5	190	390	0.031	57	73
1TZ9003-1CB2	132M			4	1470	90.4	84	15.1	14.3	13.8	7.4	49	240	350	0.046	64	80
1TZ9003-1DC2	160M			6	985	89.1	81	16.8	15	15.4	7.9	73	230	320	0.132	95	124
1TZ9003-1CA6	132M	11	15	2	2955	91.2	86	21.1	20	19.3	9.4	36	250	410	0.031	57	80
1TZ9003-1DA2	160M			2	2955	91.2	89	20.6	19.6	18.9	7.9	36	240	380	0.053	75	100
1TZ9003-1CB6	132M			4	1470	91.4	80	22.6	21.5	20.7	7.7	71	260	360	0.049	81	97
1TZ9003-1DB2	160M			4	1475	91.4	84	21.6	20.5	19.8	6.8	71	220	320	0.083	83	109
1TZ9003-1DC4	160L			6	980	90.3	80	24.2	22	22.2	6.8	107	290	280	0.164	106	138
1TZ9003-1DA3	160M	15	20	2	2960	91.9	87	28.4	27	26	8.8	48	280	430	0.061	84	110
1TZ9003-1DB4	160L			4	1475	92.1	82	30	28.5	27.5	8.5	97	250	380	0.099	100	127
1TZ9503-1EC4	180L			6	975	91.2	80	31.1	29.5	28.4	5.9	147	230	280	0.19	130	180
1TZ9003-1DA4	160L	18.5	25	2	2955	92.4	90	33.7	32	30.8	9	60	280	420	0.068	94	127
1TZ9003-1DB6	160L			4	1470	92.6	79	62.1	59	56.9	7.8	195	280	370	0.101	110	126
1TZ9503-1EB2	180M			4	1470	92.6	82	36.8	35	33.7	7.2	120	250	330	0.13	134	165
1TZ9503-1EC6	180L			6	975	91.7	77	40	38	36.6	6.9	181	260	330	0.247	150	185
1TZ9503-2AC4	200L			6	978	91.7	79	40	37	35.7	5.6	181	250	260	0.28	166	215
1TZ9003-1DA6	160L	22	30	2	2950	92.7	91	39.5	37.5	36.2	8.7	71	280	400	0.077	105	137
1TZ9503-1EA2	180M			2	2950	92.7	89	40.5	38.5	37.1	7.5	71	230	350	0.08	122	160
1TZ9503-1EB4	180L			4	1470	93	83	43.2	41	39.5	6.8	143	230	330	0.14	142	170
1TZ9503-2AC5	200L			6	978	92.2	79	45.8	43.5	41.9	5.6	215	250	260	0.32	179	230
1TZ9503-1EA6	180L	30	40	2	2950	93.3	88	55.8	53	51.1	8.6	97	260	390	0.094	140	173
1TZ9503-2AA4	200L			2	2955	93.3	87	55.8	53	51.1	7	97	250	330	0.134	173	225
1TZ9503-1EB6	180L			4	1470	93.6	79	62.1	59	56.9	8.2	195	300	380	0.173	154	193
1TZ9503-2AB5	200L			4	1470	93.6	84	57.9	55	53	7.3	195	260	310	0.22	189	240
1TZ9503-2AC6	200L			6	978	92.9	79	62.1	59	56.9	6.5	293	280	280	0.434	220	264
1TZ9503-2BC2	225M			6	982	92.9	83	59	56	54	6.6	292	260	300	0.67	-	325

Note :
The above type number 1TZ90 has a cast aluminum casing. 1TZ95/1TZ55/1TZ56 feature a cast iron casing. If you want specific materials other than those stated above, please replace your model.

IE3 / 50Hz

Totally Enclosed Fan-Cooled type, IP55
Class F insulation, Class B temperature rise, continuous rating S1

Type	Model number	Output			Full load revolution rpm	Full load efficiency %	Full load power factor %	Full load current A			Starting current	Torsional moment			Moment of inertia Kgm ²	Aluminum weight /B3 Kg	Iron weight /B3 Kg
		KW	HP	P				380V	400V	415V		Full load torsional moment NM	Starting torsional moment %	Maximum torsional moment %			
1TZ9503-2AA5	200L	37	50	2	2955	93.7	88	68.4	65	62.7	7.1	120	250	320	0.158	194	250
1TZ9503-2AB6	200L			4	1475	93.9	81	73.7	70	67.5	8.1	240	310	350	0.275	205	260
1TZ9503-2BB0	225S			4	1478	93.9	86	69.5	66	63.6	6.4	239	250	270	0.42	-	285
1TZ9503-2BC6	225M			6	982	93.3	81	74.7	71	68.4	7.1	360	300	320	0.84	-	395
1TZ9503-2CC2	250M			6	985	93.3	85	70.5	67	64.6	7	359	270	290	1	-	405
1TZ9503-2AA6	200L			45	60	2	2950	94	87	83.2	79	76.1	7.1	146	250	320	0.16
1TZ9503-2BA2	225M	2	2960			94	89	82.1	78	75.2	6.9	145	240	330	0.26	-	315
1TZ9503-2BB2	225M	4	1478			94.2	86	84.2	80	77.1	6.4	291	260	270	0.47	-	340
1TZ9503-2CC6	250M	6	986			93.7	84	87.4	83	80	7	436	280	290	1.3	-	480
1TZ9503-2DC0	280S	6	988			93.7	85	86.3	82	79	6.8	435	300	280	1.4	-	510
1TZ9503-2BA6	225M	55	75			2	2965	94.3	88	101	96	92.5	8	177	280	370	0.31
1TZ9503-2CA2	250M			2	2975	94.3	89	100	95	91.6	6.7	177	230	310	0.46	-	385
1TZ9503-2BB6	225M			4	1478	94.6	86	103.2	98	94.5	6.5	355	280	270	0.65	-	405
1TZ9503-2CB2	250M			4	1482	94.6	87	101.1	96	92.5	6.8	354	250	290	0.85	-	420
1TZ9503-2DC2	280M			6	988	94.1	85	104	99	95.4	7.2	532	320	300	1.6	-	560
1TZ9503-2CA0	250M			75	100	2	2970	94.7	90	134	127	122.4	6.8	241	220	290	0.56
1TZ9503-2DA6	280S	2	2975			94.7	89	135	128	123.4	6.8	241	240	300	0.77	-	510
1TZ9503-2CB6	250M	4	1486			95	85	141	134	129	7.9	482	300	340	1.1	-	510
1TZ9503-2DB0	280S	4	1485			95	86	140	133	128	6.9	482	250	300	1.4	-	570
1TZ9503-2DC6	280M	6	988			94.6	83	145	138	133	8.6	725	370	330	1.9	-	630
1TZ9503-3AC0	315S	6	990			94.6	84	143	136	131	7.5	723	260	310	2.6	-	750
1TZ9503-2DA2	280M	90	125	2	2975	95	90	160	152	147	7.2	289	240	310	0.94	-	590
1TZ9503-2DB2	280M			4	1485	95.2	87	165	157	151	7.2	579	260	300	1.7	-	670
1TZ9503-3AC2	315M			6	991	94.9	85	169	161	155	6.7	867	250	280	3.1	-	890
1TZ9503-2DA6	280M	110	150	2	2975	95.2	91	193	183	176	7.7	353	250	320	1.1	-	660
1TZ9503-3AA0	315S			2	2982	95.2	91	193	183	176	7.1	352	240	310	1.4	-	750
1TZ9503-2DB6	280M			4	1486	95.4	85	206	196	189	8.3	707	300	340	1.8	-	710
1TZ9503-3AB0	315S			4	1488	95.4	87	201	191	184	6.8	706	260	290	2.2	-	760
1TZ9503-3AC4	315L			6	991	95.1	84	209	199	192	7.2	1060	280	300	3.9	-	990
1TZ9503-3AA2	315M	132	175	2	2982	95.4	91	232	220	212	7.2	423	250	310	1.6	-	880
1TZ9503-3AB2	315M			4	1490	95.6	87	242	230	222	7.3	846	280	300	2.9	-	960
1TZ9503-3AC5	315L			6	991	95.4	84	253	240	231	7.2	1272	270	300	4.4	-	1110
1TZ9503-3AA4	315L	160	215	2	2982	95.6	92	279	265	255	7.8	512	280	330	1.9	-	980
1TZ9503-3AB4	315L			4	1490	95.8	87	289	275	265	7.3	1025	290	310	3.1	-	990
1TZ9503-3AC6	315L			6	991	95.6	83	305	290	280	7.7	1542	330	350	4.6	-	1160
1TZ9503-3AA5	315L	200	270	2	2982	95.8	92	347	330	318	7.2	640	250	300	2.3	-	1150
1TZ9503-3AB5	315L			4	1488	96	88	358	340	328	7.4	1284	320	300	3.7	-	1190
1TZ5503-3AC7	315L			6	992	95.8	82	384	365	352	7.5	1925	300	320	6.28	-	1410
1TZ5503-3AA6	315L	250	335	2	2986	95.8	87	458	435	419	9.1	800	300	400	2.7	-	1310
1TZ5503-3AB6	315L			4	1490	96	85	463	440	424	7.9	1600	280	320	4.3	-	1290
1TZ5503-3AC8	315L			6	992	95.8	81	489	465	448	8.2	2407	320	330	8	-	1700
1TZ5503-3AA7	315L	315	420	2	2986	95.8	87	579	550	530	9.9	1010	350	420	3.3	-	1520
1TZ5503-3AB7	315L			4	1490	96	83	600	570	550	8.5	2000	320	350	5.4	-	1560
1TZ5603-3BC2	335M			6	993	95.8	82	611	580	559	7.8	3029	290	320	11.6	-	2040
1TZ5603-3BA3	355M	355	476	2	2988	95.8	89	632	600	578	8.9	1130	260	400	4.7	-	2100
1TZ5603-3BB3	355M			4	1492	96	86	653	620	598	7.9	2250	290	280	6.8	-	2020
1TZ5603-3BC3	355M			6	993	95.8	83	674	640	617	8.4	3414	290	330	13.7	-	2250
1TZ5603-3BA4	355M	400	536	2	2986	95.8	92	695	660	636	8.5	1280	260	340	5.4	-	2240
1TZ5603-3BB4	355M			4	1492	96	84	758	720	694	8.4	2550	340	300	7.2	-	2110
1TZ5603-3BC4	355L			6	994	95.8	96	758	720	694	8.1	3843	280	300	13.4	-	2240
1TZ5603-3BA5	355M	500	670	2	2988	95.8	89	895	850	819	8.9	1600	300	380	5.8	-	2340
1TZ5603-3BB5	355M			4	1490	96	84	937	890	858	7.8	3200	300	260	8.5	-	2290

Note 1:
The above type number 1TZ90 has a cast aluminum casing. 1TZ95/1TZ55/1TZ56 feature a cast iron casing. If you want specific materials other than those stated above, please replace your model.

IE3/60Hz

Totally Enclosed Fan-Cooled type, IP55
Class F insulation, Class B temperature rise, continuous rating S1

Type	Model number	Output		P	Full load revolution speed rpm	Full load efficiency %	Full load power factor %	Full load current A			Starting current	Torsional moment			Moment of inertia Kgm2	Aluminum weight /B3 Kg	Iron weight /B3 Kg
		KW	HP					220V	380V	460V		Starting torsional moment %	Maximum torsional moment %	Full load torsional moment NM			
1TZ9503-0CC2	71M	0.18	1/4	6	1110	67.5	63	1.11	0.64	0.53	3.5	280	290	1.5	0.001	-	12
1TZ9503-0CB2	71M	0.25	1/3	4	1715	73.4	68	1.31	0.76	0.63	4.9	290	310	1.4	0.00095	-	13
1TZ9503-0CC3	71M			6	1110	71.4	64	1.44	0.83	0.69	3.9	320	320	2.2	0.0015	-	16
1TZ9503-0CB3	71M	0.37	1/2	4	1720	78.2	66	1.88	1.09	0.9	5.7	360	380	2.0	0.0014	-	16
1TZ9003-0DC2	80M			6	1150	75.3	61	2.1	1.22	1.01	5.0	270	330	3.1	0.0025	12	19
1TZ9003-0DB2	80M	0.55	3/4	4	1750	81.1	74	2.40	1.39	1.15	6.9	270	380	3	0.0021	11	18
1TZ9003-0DC3	80M			6	1145	81.7	63	2.80	1.62	1.34	5.3	280	340	4.6	0.0031	14	22
1TZ9003-0DA2	80M	0.75	1	2	3480	77.0	84	3.05	1.76	1.45	7.1	300	360	2	0.0011	11	18
1TZ9043-0DB3	80M			4	1760	85.5	71	3.24	1.92	1.59	8.3	310	470	4.1	0.0029	14	22
1TZ9003-0EC0	90S			6	1155	82.5	65	3.65	2.10	1.76	5.3	240	310	6.2	0.004	16	26
1TZ9003-0DA3	80M	1.1	1.5	2	3500	84.0	83	4.15	2.40	1.98	8.4	330	400	3.0	0.0013	12	21
1TZ9003-0EB0	90S			4	1750	86.5	75	4.45	2.60	2.15	8.2	340	440	6.0	0.0036	16	25
1TZ9043-1AC3	100L			6	1180	87.5	69	4.80	2.75	2.30	6.7	240	330	8.9	0.011	30	49
1TZ9003-0EA0	90S	1.5	2	2	3525	85.5	84	5.50	3.15	2.60	9.8	310	490	4	0.0021	15	26
1TZ9003-0EB4	90L			4	1755	86.5	77	5.90	3.40	2.85	8.4	300	430	8.2	0.0049	19	31
1TZ9043-1BC1	112M			6	1175	88.5	76	6.10	3.55	3.25	6.2	200	280	14	0.017	34	53
1TZ9003-0EA4	90L	2.2	3	2	3530	86.5	87	7.70	4.45	3.65	9.6	300	490	6	0.0031	19	32
1TZ9003-1AB4	100L			4	1770	89.5	81	8.00	4.60	3.67	8.7	250	430	12	0.014	30	40
1TZ9043-1CC1	132S			6	1180	89.5	77	8.70	5.00	4.65	7.1	200	310	21	0.0037	52	60
1TZ9003-1AA4	100L	3	4	2	3530	88.5	87	10.2	5.90	4.90	9.6	310	520	8.1	0.0054	26	36
1TZ9003-1AB5	100L			4	1765	89.5	81	10.9	6.30	5.20	8.6	260	430	16	0.014	30	40
1TZ9043-1CC0	132S			6	1185	89.5	75	11.7	6.80	5.60	7.5	230	330	24	0.037	52	60
1TZ9003-1BA2	112M	4	5.5	2	3560	88.5	89	13.3	7.70	6.40	8.2	300	450	12	0.012	34	45
1TZ9003-1BB2	112M			4	1770	89.5	81	14.5	8.40	6.90	8.2	290	430	20	0.017	34	46
1TZ9003-1CC2	132SM			6	1175	89.5	73	16.1	9.30	7.60	6.8	200	310	30	0.037	52	64
1TZ9003-1CA0	132S	5.5	7.5	2	3555	89.5	89	18.1	10.5	8.7	8.6	210	420	15	0.024	43	58
1TZ9003-1CB0	132S			4	1775	91.7	81	19.4	11.3	9.3	8.2	260	390	30	0.034	54	74
1TZ9043-1CC3	132M			6	1180	91.0	74	21.5	12.4	10.3	7.2	230	330	45	0.046	64	76
1TZ9003-1CA1	132S	7.5	10	2	3560	90.2	91	24.0	13.9	11.5	9.4	220	450	20	0.031	57	73
1TZ9043-1CB2	132M			4	1770	91.7	83	26.0	15.0	12.4	9.6	270	420	41	0.046	64	80
1TZ9043-1DC2	160M			6	1185	91.0	75	29.0	16.7	13.8	5.9	240	260	60	0.098	93	124
1TZ9003-1CA6	132M	11	15	2	3565	91.0	86	37.0	21.5	17.6	9.6	250	520	29	0.031	54	80
1TZ9003-1DA2	160M			2	3560	91.0	88	36.0	21.0	17.2	8.9	320	430	30	0.053	75	100
1TZ9003-1CB6	132M			4	1775	92.4	79	39.5	23.0	19.0	8.7	310	410	59	0.049	81	97
1TZ9003-1DB2	160M			4	1780	92.4	83	37.5	22.0	18.0	7.9	230	370	59	0.071	83	109
1TZ9043-1DC4	160L			6	1180	91.7	75	42.0	24.5	20.5	5.8	230	260	89	0.12	115	138
1TZ9003-1DA3	160M			15	20	2	3565	91.0	87	49.5	29.0	24.0	10.0	320	490	40	0.061
1TZ9003-1DB4	160L	4	1780			93.0	81	52.0	30.5	25.0	9.5	290	430	80	0.085	100	127
1TZ9503-1EC4	180L	6	1178			91.7	79	54.0	31.5	26.0	7.2	240	320	122	0.19	130	180
1TZ9003-1DA4	160L	18.5	25	2	3560	91.7	89	59.0	34.5	28.5	10.2	300	480	50	0.068	94	127
1TZ9003-1DB6	160L			4	1780	93.6	75	69.0	40.0	33.0	9.0	300	420	99	0.099	110	126
1TZ9503-1EB2	180M			4	1775	93.6	81	64.0	37.0	30.5	8.7	260	380	100	0.13	134	166
1TZ9503-1EC6	180L			6	1180	93	75	70.0	40.5	33.5	7.9	290	370	150	0.247	150	185
1TZ9503-2AC4	200L			6	1180	93.0	78	67.0	38.5	32.0	7.0	270	290	150	0.28	166	215
1TZ9003-1DA6	160L			22	30	2	3560	91.7	90	70.0	40.5	33.5	9.7	310	450	59	0.073
1TZ9503-1EA2	180M	2	3560			91.7	89	71.0	41.0	34.0	9.0	250	390	59	0.08	122	160
1TZ9503-1EB4	180L	4	1775			93.6	81	76.0	44.0	36.5	8.3	240	360	118	0.14	142	178
1TZ9503-2AC5	200L	6	1180			93.0	79	79.0	45.5	37.5	6.3	260	280	178	0.32	179	230
1TZ9503-1EA6	180L	30	40	2	3560	92.4	87	98.0	57.0	47.0	8.8	290	450	80	0.094	140	173
1TZ9503-2AA4	200L			2	3560	92.4	87	98.0	57.0	47.0	8.5	300	370	80	0.134	173	220
1TZ9503-1EB6	180L			4	1775	94.1	78	107.0	63.0	51.0	8.8	310	410	161	0.173	154	193
1TZ9503-2AB5	200L			4	1778	94.1	83	101.0	58.0	48.0	8.8	260	350	161	0.24	189	240
1TZ9503-2AC6	200L			6	1182	94.1	77	109.0	63.0	52.0	7.6	320	320	242	0.434	220	264
1TZ9503-2BC2	225M			6	1185	94.1	82	102.0	59.0	49.0	7.6	290	330	242	0.67	-	325

Note 1: The above type number 1TZ90 has a cast aluminum casing. 1TZ95/1TZ55/ITZ56 feature a cast iron casing. If you want specific materials other than those stated above, please replace your model.

Note 2: Model numbers 63-160 in our normal inventories have 1TZ90 cast aluminum casing, and model numbers 180 to 355 feature 1TZ95/1TZ55/ITZ56 cast iron casing. Please contact us for other specifications.

IE3/60Hz

Totally Enclosed Fan-Cooled type, IP55
Class F insulation, Class B temperature rise, continuous rating S1

Type	Model number	Output		P	Full load revolution speed rpm	Full load efficiency %	Full load power factor %	Full load current A			Starting current	Torsional moment			Moment of inertia Kgm2	Aluminum weight /B3 Kg	Iron weight /B3 Kg
		KW	HP					220V	380V	460V		Starting torsional moment %	Maximum torsional moment %	Full load torsional moment NM			
1TZ9503-2AA5	200L	37	50	2	3560	93	88	119	69	57	7.6	270	330	99	0.158	194	250
1TZ9503-2AB6	200L			4	1780	94.5	80	128	74	61	9	330	400	198	0.275	205	260
1TZ9503-2BB0	225S			4	1782	94.5	85	121	70	58	7.5	280	310	198	0.42	-	285
1TZ9503-2BC6	225M			6	1186	94.1	80	129	75	62	8.2	330	350	298	0.84	-	395
1TZ9503-2CC2	250M			6	1188	94.1	83	124	72	59	8	310	310	297	1	-	405
1TZ9503-2AA6	200L	45	60	2	3560	93.6	86	147	85	70	8.4	300	370	121	0.17	194	245
1TZ9503-2BA2	225M			2	3570	93.6	88	143	83	69	7.6	270	350	120	0.26	-	315
1TZ9503-2BB2	225M			4	1782	95	84	148	86	71	7.2	290	300	241	0.47	-	340
1TZ9503-2CC6	250M			6	1188	94.5	83	151	87	72	8.1	280	320	362	1.3	-	480
1TZ9503-2DC0	280S			6	1190	94.5	83	151	87	72	7.7	330	310	361	1.4	-	510
1TZ9503-2BA6	225M	55	75	2	3570	93.6	88	175	101	84	8.9	320	400	147	0.31	-	390
1TZ9503-2CA2	250M			2	3578	93.6	89	173	100	83	7.3	250	330	147	0.46	-	385
1TZ9503-2BB6	225M			4	1782	95.4	85	178	103	85	7.4	310	300	295	0.65	-	415
1TZ9503-2CB2	250M			4	1786	95.4	86	176	102	84.4	7.6	280	320	294	0.85	-	420
1TZ9503-2DC2	280M			6	1190	94.5	83	184	107	88	7.9	360	330	441	1.6	-	560
1TZ9503-2CA6	250M	75	100	2	3575	94.1	90	230	135	111	7.5	250	320	200	0.56	-	470
1TZ9503-2DA0	280S			2	3578	94.1	89	235	136	112	7.6	270	320	200	0.77	-	510
1TZ9503-2CB6	250M			4	1788	95.4	84	245	142	117	8.8	340	380	401	1.1	-	510
1TZ9503-2DB0	280S			4	1788	95.4	85	245	141	116	7.7	280	330	401	1.39	-	570
1TZ9503-2DC6	280M			6	1190	95	82	255	146	121	9.5	420	360	602	1.9	-	620
1TZ9503-3AC0	315S			6	1192	95	82	255	146	121	8.4	310	330	601	2.6	-	750
1TZ9503-2DA2	280M	90	125	2	3578	95	90	275	160	132	8.1	270	330	240	0.94	-	590
1TZ9503-2DB2	280M			4	1788	95.4	87	285	165	136	8	290	330	481	1.7	-	670
1TZ9503-3AC2	315M			6	1192	95	84	295	171	142	7.7	270	300	721	3.1	-	890
1TZ9503-2DA6	280M	110	150	2	3578	95	91	335	193	160	8.5	290	350	294	1.1	-	670
1TZ9503-3AA0	315S			2	3585	95	91	335	193	160	8	260	330	293	1.39	-	750
1TZ9503-2DB6	280M			4	1755	95.8	85	355	205	170	9.2	340	370	587	1.8	-	730
1TZ9503-3AB0	315S			4	1790	95.8	86	350	205	168	7.5	300	310	587	2.2	-	760
1TZ9503-3AC4	315L			6	1192	95.8	83	365	210	174	8.2	320	340	881	3.9	-	990
1TZ9503-3AA2	315M	132	175	2	3585	95.4	91	400	230	191	8	280	340	352	1.6	-	880
1TZ9503-3AB2	315M			4	1790	96.2	87	415	240	198	8.2	310	320	704	2.9	-	960
1TZ9503-3AC5	315L			6	1192	95.8	84	430	250	205	8.4	310	330	1057	4.4	-	1130
1TZ9503-3AA4	315L	160	215	2	3588	95.4	91	485	280	230	8.8	320	350	426	1.9	-	980
1TZ9503-3AB4	315L			4	1791	96.2	87	500	290	240	8.4	330	330	853	3.1	-	990
1TZ9503-3AC6	315L			6	1192	95.8	82	530	310	255	9	330	380	1282	4.6	-	1260
1TZ9503-3AA5	315L	200	270	2	3586	95.8	92	600	345	285	8.3	320	330	533	2.3	-	1150
1TZ9503-3AB5	315L			4	1791	96.2	87	630	365	300	8.7	350	320	1066	3.7	-	1190
1TZ5503-3AC7	315L			6	1194	95.8	81	-	390	325	9	320	350	1600	6.28	-	1410
1TZ5503-3AA6	315L	250	335	2	3588	95.8	88	-	450	370	11	410	460	670	2.82	-	1340
1TZ5503-3AB6	315L			4	1791	96.2	85	-	465	385	8.6	310	350	1333	4.27	-	1290
1TZ5503-3AC8	315L			6	1194	95.8	81	-	490	405	9.5	360	370	1999	8	-	1700
1TZ5503-3AA7	315L	315	420	2	3588	95.8	87	-	570	475	11	410	460	840	3.27	-	1520
1TZ5503-3AB7	315L			4	1792	96.2	83	-	600	495	9.4	340	370	1679	5.39	-	1560
1TZ5603-3BC2	355M			6	1194	95.8	82	-	610	500	9.2	320	360	2519	11.6	-	2040
1TZ5603-3BA3	355M	355	475	2	3590	95.8	89	-	630	520	9.5	260	450	944	4.74	-	2100
1TZ5603-3BB3	355M			4	1793	96.2	85	-	660	540	9	340	310	1891	6.76	-	2020
1TZ5603-3BC3	355M			6	1194	95.8	82	-	690	570	9.4	320	370	2839	13.7	-	2250
1TZ5603-3BA4	355L	400	535	2	3590	95.8	91	-	700	580	9.8	330	400	1064	5.36	-	2240
1TZ5603-3BB4	355L			4	1794	96.2	84	-	750	620	9.5	410	330	2129	7.16	-	2110
1TZ5603-3BC4	355L			6	1194	95.8	84	-	760	620	9.3	320	330	3199	13.4	-	2240
1TZ5603-3BA5	355L	500	670	2	3590	95.8	89	-	890	740	10	340	440	1330	5.76	-	2340
1TZ5603-3BB5	355L			4	1792	96.2	86	-	920	760	9.5	350	370	2664	8.36	-	2290

Note 1:

The above type number 1TZ90 has a cast aluminum casing. 1TZ95/1TZ55/1TZ56 feature a cast iron casing. If you want specific materials other than those stated above, please replace your model.

Note 2:

The models 63 - 160 in our normal inventories have 1TZ90 cast aluminum casing, and models 180 to 355 feature 1TZ95/1TZ55/1TZ56 cast iron casing. Please contact us for other specifications.

Nine Fine Original imported motor from Europe

IE1/50Hz

Totally Enclosed Fan-Cooled type, IP55
Class F insulation, Class B temperature rise, continuous rating S1

Type	Model number	Output		P	Full load revolution speed rpm	Full load efficiency 100%	Full load power factor 100%	Full load current A			Starting current	Torsional moment			Moment of inertia Kgm ²	Approximate weight IM B3 Kg
		KW	HP					380V	400V	415V		Full load torsional moment NM	Starting torsional moment %	Maximum torsional moment %		
1TZ9002-0BA2	63M	0.18	1/4	2	2805	52.8	79.0	0.66	0.62	0.60	3.4	0.6	170	220	0.00018	4.0
1TZ9002-0BB3	63M			4	1360	57.0	71.0	0.67	0.64	0.62	2.8	1.3	190	210	0.00037	4.0
1TZ9002-0CC2	71M			6	800	45.5	67.0	0.88	0.84	0.81	2.0	2.1	190	200	0.00055	5.0
1TZ9002-0BA3	63M	0.25	1/3	2	2835	58.2	75.0	0.87	0.83	0.80	3.6	0.8	190	260	0.00022	4.0
1TZ9002-0CB2	71M			4	1365	61.5	73.0	0.84	0.8	0.77	3	1.7	180	200	0.00052	5
1TZ9002-0CC3	71M			6	860	52.1	71.0	1.03	0.98	0.94	2.2	2.8	200	200	0.0008	6
1TZ9002-0CA2	71M	0.37	1/2	2	2755	63.9	79.0	1.12	1.06	1.02	3.4	1.3	220	220	0.00029	5
1TZ9002-0CB3	71M			4	1350	66.0	75.0	1.14	1.08	1.04	3.2	2.6	200	200	0.00077	6
1TZ9002-0DC2	80M			6	915	59.7	70.0	1.35	1.28	1.23	2.7	3.9	160	180	0.00198	9.0
1TZ9002-0CA3	71M			2	2750	69.0	79.0	1.54	1.46	1.41	3.7	1.9	220	220	0.00041	6.0
1TZ9002-0DB2	80M			4	1385	70.0	79.0	1.52	1.44	1.39	3.7	3.8	210	220	0.0014	9.0
1TZ9002-0DC3	80M			6	900	65.8	72.0	1.77	1.68	1.62	2.7	5.8	170	190	0.0017	12
1TZ9002-0DA2	80M	0.75	1	2	2835	72.1	86.0	1.84	1.75	1.69	5.2	2.5	210	230	0.00079	9.0
1TZ9002-0DB3	80M			4	1385	72.1	76.0	1.95	1.85	1.78	3.6	5.2	210	230	0.0017	11
1TZ9002-0EC0	90S			6	940	70.0	67.0	2.42	2.30	2.22	3.8	7.6	200	220	0.0033	13
1TZ9002-0DA3	90S	1.1	1.5	2	2840	75.0	86.0	2.58	2.45	2.36	5.7	3.7	250	250	0.001	12
1TZ9002-0EB0	90S			4	1405	75.0	81.0	2.63	2.50	2.41	4.5	7.5	210	230	0.0024	12
1TZ9002-0EC4	90L			6	925	72.9	69.0	3.32	3.15	3.04	3.8	11.0	220	240	0.004	15
1TZ9002-0EA0	90S	1.5	2	2	2835	77.2	80.0	3.47	3.30	3.18	5.5	5.1	260	290	0.0014	13
1TZ9002-0EB4	90L			4	1410	77.2	80.0	3.53	3.35	3.23	4.7	10	240	260	0.0033	15
1TZ9002-1AC4	100L			6	940	75.2	74.0	4.11	3.90	3.76	4.0	15.0	200	220	0.0065	19
1TZ9002-0EA4	90L	2.2	3	2	2855	79.7	85.0	4.95	4.70	4.53	6.5	7.4	280	320	0.0018	14
1TZ9002-1AB4	100L			4	1425	79.7	81.0	5.16	4.90	4.72	5.1	15.0	220	230	0.0059	18
1TZ9002-1BC2	112M			6	940	77.7	72.0	6.00	5.70	5.49	4.6	22.0	260	270	0.0092	25
1TZ9002-1AA4	100L	3	4	2	2835	81.5	87.0	6.42	6.10	5.88	6.4	10.0	320	350	0.0034	20
1TZ9002-1AB5	100L			4	1425	81.5	85.0	6.63	6.30	6.07	5.4	20.0	240	260	0.0078	22
1TZ9002-1BC6	112M			6	945	79.7	72.0	7.89	7.50	7.23	4.6	30.0	290	300	0.013	32
1TZ9002-1CC0	132S			6	955	79.7	74.0	7.68	7.30	7.04	4.6	30.0	200	260	0.017	34
1TZ9002-1BA2	112M	4	5.5	2	2935	83.1	85.0	8.63	8.20	7.90	8.3	13.0	330	420	0.0067	25
1TZ9002-1BB2	112M			4	1435	83.1	83.0	8.84	8.40	8.10	6.1	27.0	250	290	0.0100	27
1TZ9002-1CC2	132SM			6	955	81.4	76.0	9.79	9.30	8.96	5.2	40.0	230	260	0.0210	39
1TZ9002-1BA6	112M	5.5	7.5	2	2935	84.7	86.0	11.5	10.90	10.50	7.5	18.0	290	380	0.0085	31
1TZ9002-1CA0	132S			2	2910	84.7	88.0	11.3	10.7	10.3	5.7	18.0	180	260	0.013	35
1TZ9002-1CB0	132S			4	1450	84.7	82.0	11.8	11.2	10.8	5.7	36.0	230	270	0.0190	38
1TZ9002-1CC3	132M			6	955	83.1	75.0	13.4	12.7	12.2	5.7	55.0	270	300	0.0270	48
1TZ9002-1CA1	132S	7.5	10	2	2925	86.0	88.0	15.1	14.3	13.8	6.8	24.0	220	310	0.0160	40
1TZ9002-1CB2	132M			4	1450	86.0	82.0	16.2	15.4	14.8	6.6	49.0	260	310	0.0240	44
1TZ9002-1DC2	160M			6	970	84.7	73.0	18.4	17.5	16.9	5.5	74.0	210	290	0.0560	72
1TZ9002-1CA6	132M	11	15	2	2920	87.6	90.0	21.1	20.0	19.3	7.5	36.0	280	370	0.0220	53
1TZ9002-1DA2	160M			2	2925	87.6	85.0	22.6	21.5	20.7	5.7	36.0	200	270	0.0300	60
1TZ9002-1DB2	160M			4	1460	87.6	81.0	23.7	22.5	21.7	6.9	72.0	270	330	0.0440	62
1TZ9002-1DC4	160L			6	965	86.4	77.0	25.3	24.0	23.1	5.9	109	190	270	0.0780	92
1TZ9002-1DA3	160M	15	20	2	2935	88.7	85.0	30.0	28.5	27.5	6.8	49.0	240	320	0.0360	68
1TZ9002-1DB4	160L			4	1460	88.7	82.0	31.6	30.0	28.9	7.5	98.0	300	360	0.0560	73
1TZ9502-1EC4	180L			6	975	87.7	77.0	33.7	32.0	30.8	6.1	147	230	300	0.1700	155

IE1 / 50Hz

Totally Enclosed Fan-Cooled type, IP55
Class F insulation, Class B temperature rise, continuous rating S1

Type	Model number	Output		P	Full load revolution speed rpm	Full load efficiency 100%	Full load power factor 100%	Full load current A			Starting current	Torsional moment			Moment of inertia Kgm ²	Approximate weight IM B3 Kg
		KW	HP					380V	400V	415V		Full load torsional moment NM	Starting torsional moment %	Maximum torsional moment %		
1TZ9002-1DA4	160L	18.5	25	2	2935	89.3	87.0	36.2	34.5	33.3	7.6	60.0	270	340	0.0440	78
1TZ9502-1EB2	180M			4	1468	89.3	85.0	36.8	35.0	33.7	7.3	120	220	310	0.1300	170
1TZ9502-1EC6	180L			6	970	88.6	77.0	41.1	39.0	37.6	5.9	182	220	290	0.2060	165
1TZ9502-2AC4	200L			6	978	88.6	79.0	40.0	38.0	36.6	6.3	181	250	260	0.2500	200
1TZ9002-1DA6	160L	22	30	2	2935	89.9	90.0	41.1	39.0	37.6	7.5	72.0	260	340	0.0490	85
1TZ9502-1EA2	180M			2	2945	89.9	87.0	42.6	40.5	39.0	7.7	71.0	250	350	0.0690	150
1TZ9502-1EB4	180L			4	1465	89.9	83.0	44.7	42.5	41.0	8.0	143	270	360	0.1300	170
1TZ9502-2AC5	200L			6	980	89.2	79.0	47.4	45.0	43.4	6.8	214	280	290	0.3000	220
1TZ9502-1EA6	180L	30	40	2	2940	90.7	89.0	56.8	54.0	52.1	8.1	97.0	240	350	0.0940	180
1TZ9502-2AA4	200L			2	2960	90.7	79.0	63.2	60.0	57.8	7.3	97.0	250	360	0.1240	195
1TZ9502-1EB6	180L			4	1465	90.7	79.0	63.2	60.0	57.8	7.2	196	260	340	0.1590	185
1TZ9502-2AB5	200L			4	1472	90.7	83.0	61.1	58.0	55.9	6.9	195	230	310	0.2000	220
1TZ9502-2AC6	200L			6	975	90.2	78.0	65.3	62.0	59.8	6.0	294	260	270	0.3810	245
1TZ9502-2BC2	225M			6	978	90.2	82.0	62.1	59.0	56.9	6.0	293	270	250	0.4900	270
1TZ9502-2AA5	200L	37	50	2	2955	91.2	88.0	70.5	67.0	64.6	8.2	120	270	350	0.1500	230
1TZ9502-2AB6	200L			4	1470	91.2	82.0	74.7	71.0	68.4	6.8	240	240	290	0.2460	240
1TZ9502-2BB0	225S			4	1475	91.2	85.0	72.6	69.0	66.5	7.0	240	230	320	0.3700	260
1TZ9502-2CC2	250M			6	980	90.8	82.0	75.8	72.0	69.4	6.0	361	270	240	0.7600	330
1TZ9502-2AA6	200L	45	60	2	2955	91.7	85.0	87.4	83.0	80.0	8.1	145	250	360	0.1760	245
1TZ9502-2BA2	225M			2	2960	91.7	88.0	84.2	80.0	77.1	6.7	145	230	300	0.2200	280
1TZ9502-2BB2	225M			4	1475	91.7	86.0	86.3	82.0	79.0	7.2	291	260	320	0.4500	290
1TZ9502-2DC0	280S			6	986	91.4	84.0	89.5	85.0	81.9	7.0	436	260	260	1.1000	440
1TZ9502-2BA6	225M	55	75	2	2960	92.1	88.0	103	98.0	95.0	7.3	177	250	320	0.2700	330
1TZ9502-2CA2	250M			2	2970	92.1	88.0	103	98.0	94.5	6.7	177	200	290	0.4000	360
1TZ9502-2BB6	225M			4	1475	92.1	86.0	105	100	96.0	6.7	356	250	260	0.4900	320
1TZ9502-2CB2	250M			4	1475	92.1	85.0	106	101	97.4	6.1	356	240	260	0.6900	370
1TZ9502-2DC2	280M			6	986	91.9	85.0	107	102	98.3	6.7	533	260	260	1.3000	500
1TZ9502-2CA6	250M			75	100	2	2970	92.7	87.0	141	134	141	7.3	241	240	310
1TZ9502-2DA0	280S	2	2975			92.7	86.0	143	136	143	6.8	241	220	380	0.7200	470
1TZ9502-2CB6	250M	4	1482			92.7	84.0	146	139	146	7.4	483	250	300	0.8600	440
1TZ9502-2DB0	280S	4	1485			92.7	85.0	144	137	144	7.0	482	230	280	1.2000	500
1TZ9502-2DC6	280M	6	985			92.6	84.0	146	139	146	7.0	727	290	270	1.7000	560
1TZ9502-3AC0	315S	6	988			92.6	83.0	148	141	148	7.1	725	250	270	2.1000	660
1TZ9502-2DA2	280M	90	125	2	2975	93.0	88.0	167	159	153	7.1	289	250	310	0.8300	530
1TZ9502-2DB2	280M			4	1482	93.0	87.0	169	161	155	6.5	580	220	280	1.4000	560
1TZ9502-3AC2	315M			6	988	92.9	83.0	177	168	162	7.3	870	260	260	2.5000	740
1TZ9502-2DA6	280M	110	150	2	2975	93.3	90.0	199	189	182	7.3	355	240	310	1.0000	620
1TZ9502-3AA0	315S			2	2982	93.3	86.0	208	198	191	7.5	352	230	330	1.2000	680
1TZ9502-2DB6	280M			4	1486	93.3	85.0	211	200	193	8.0	710	260	330	1.7000	680
1TZ9502-3AB0	315S			4	1488	93.3	84.0	216	205	198	6.5	706	230	270	1.9000	690
1TZ9502-3AC4	315L			6	988	93.3	86.0	208	198	191	6.8	1063	260	280	3.2000	880
1TZ9502-3AA2	315M	132	175	2	2982	93.5	89.0	242	230	222	7.6	423	230	300	1.4000	740
1TZ9502-3AB2	315M			4	1488	93.5	85.0	253	240	231	6.8	847	250	270	2.2000	760
1TZ9502-3AC5	315M			6	988	93.5	86.0	247	235	227	7.5	1276	300	290	4.0000	1030
1TZ9502-3AA4	315L	160	215	2	2982	93.8	91.0	284	270	260	7.4	512	230	290	1.6000	880
1TZ9502-3AB4	315L			4	1486	93.8	86.0	300	285	275	7.2	1028	270	270	2.9000	940
1TZ9502-3AC6	315L			6	988	93.8	86.0	300	285	275	7.7	1546	310	300	4.7000	1160
1TZ9502-3AA5	315L	200	270	2	2982	94.0	92.0	353	335	323	7.1	640	220	280	2.1000	1000
1TZ9502-3AB5	315L			4	1486	94.0	87.0	374	355	342	6.9	1285	250	270	3.5000	1140

Nine Fine Original imported motor from Europe

IE1⁺/60Hz

**Totally Enclosed Fan-Cooled type, IP55
Class F insulation, Class B temperature rise, continuous rating S1**

Type	Model number	Output		P	Full load revolution speed rpm	Full load efficiency %	Full load power factor %	Full load current A			Starting current	Torsional moment			Moment of inertia Kgm ²	Approximate weight IM B3 Kg
		KW	HP					220V	380V	460V		Full load torsional moment NM	Starting torsional moment %	Maximum torsional moment %		
1TZ9002-0BA2	63M	0.18	1/4	2	3405	62.0	78.0	0.98	0.57	0.47	3.9	0.6	190	250	0.00018	4
1TZ9002-0BB3	63M			4	1670	66.0	68.0	1.05	0.61	0.50	3.2	1.2	210	230	0.00037	4
1TZ9002-0CC2	71M			6	1015	52.5	65.0	1.38	0.8	0.66	2.3	2.0	200	210	0.0006	5
1TZ9002-0BA3	63M	0.25	1/3	2	3440	64.0	74.0	1.39	0.8	0.66	4.2	0.8	210	280	0.0002	4
1TZ9002-0CB2	71M			4	1665	68.0	71.0	1.36	0.79	0.65	3.4	1.7	180	200	0.00052	5
1TZ9002-0CC3	71M			6	1070	57.5	70.0	1.63	0.94	0.78	2.5	2.6	200	210	0.0008	6
1TZ9002-0CA2	71M	0.37	1/2	2	3355	70.0	79.0	1.76	1.02	0.84	4	1.2	230	240	0.00022	5
1TZ9002-0CB3	71M			4	1650	70.0	75.0	1.85	1.07	1.03	3.6	2.5	210	210	0.0008	6
1TZ9002-0DC2	80M			6	1120	62.0	68.0	2.30	1.33	1.28	3	3.6	170	210	0.00198	9
1TZ9002-0CA3	71M	0.55	3/4	2	3350	72.0	79.0	2.54	1.47	1.39	4.2	1.8	240	240	0.0003	6
1TZ9002-0DB2	80M			4	1685	74.0	78.0	2.50	1.45	1.20	4.3	3.5	230	250	0.0014	9
1TZ9002-0DC3	80M			6	1110	66.0	69.0	3.17	1.84	1.52	3.1	5.4	190	210	0.00238	12
1TZ9002-0DA2	80M	0.75	1	2	3435	74.0	86.0	3.55	2.06	1.7	5.9	2.4	230	250	0.00079	10
1TZ9002-0DB3	80M			4	1690	74.0	75.0	4.06	2.35	1.94	4.2	4.9	230	260	0.00377	11
1TZ9002-0EC0	90S			6	1140	72.0	66.0	4.70	2.72	2.25	4.2	7.2	200	250	0.00333	13
1TZ9002-0DA3	90S	1.1	1.5	2	3435	78.5	87.0	4.91	2.84	2.35	6.5	3.5	270	260	0.00223	12
1TZ9002-0EB0	90S			4	1705	75.0	81.0	5.23	3.03	2.5	5.0	7.1	220	250	0.0050	12
1TZ9002-0EC4	90L			6	1125	75.0	69.0	6.48	3.75	3.1	4.3	10.8	220	260	0.00402	15
1TZ9002-0EA0	90S	1.5	2	2	3425	81	86.0	6.59	3.81	3.15	6.0	4.9	260	310	0.0036	13
1TZ9002-0EB4	90L			4	1710	78.7	81	7.00	4.06	3.35	5.4	9.8	260	280	0.00596	15
1TZ9002-1AC4	100L			6	1140	77.0	78.0	6.60	3.80	3.65	4.3	12.6	210	240	0.0065	20
1TZ9002-0EA4	90L	2.2	3	2	3450	81.5	86.0	9.51	5.51	4.55	7.0	7.1	280	330	0.0046	14
1TZ9002-1AB4	100L			4	1720	83.0	82.0	8.50	4.90	4.70	5.8	14.2	220	270	0.0059	19
1TZ9002-1BC2	112M			6	1140	78.5	73.0	11.71	6.78	5.60	5.1	21.5	260	280	0.0092	25
1TZ9002-1AA4	100L	3	4	2	3430	84.5	88.0	10.6	6.10	5.04	6.7	9.6	340	320	0.0034	20
1TZ9002-1AB5	100L			4	1725	85.5	86.0	10.7	6.20	5.12	6.0	19.1	220	230	0.0078	22
1TZ9002-1BC6	112M			6	1140	83.5	72.0	15.1	8.72	7.20	4.5	29	290	300	0.0130	32
1TZ9002-1CC0	132S			6	1155	85.5	75.0	12.3	7.11	5.87	4.6	28.5	190	200	0.0167	34
1TZ9002-1BA2	112M	4	5.5	2	3535	84.5	87.0	14.2	8.20	7.80	7.5	12.4	270	370	0.0067	25
1TZ9002-1BB2	112M			4	1735	85.0	83.0	14.4	8.30	8.10	5.8	25.3	210	260	0.0102	27
1TZ9002-1CC2	132SM			6	1155	83.5	77.0	15.7	9.11	8.90	4.7	38.2	200	240	0.0212	39
1TZ9002-1BA6	112M	5.5	7.5	2	3525	86.0	88.0	14.2	8.2	6.77	7.5	12.4	270	370	0.0067	25
1TZ9002-1CA0	132S			2	3505	86.5	90.0	18.5	10.7	8.84	5.8	17.2	190	270	0.0127	35
1TZ9002-1CB0	132S			4	1745	87.0	84.0	19.6	11.4	10.80	6.7	34.4	220	280	0.0186	38
1TZ9002-1CC3	132M			6	1155	85.0	76.0	21.7	12.57	12.2	5.2	52.3	240	260	0.0273	53
1TZ9002-1CA1	132S	7.5	10	2	3530	87.5	88.0	25.6	14.8	12.2	6.5	23.3	220	310	0.0160	45
1TZ9002-1CB2	132M			4	1750	87.5	84.0	26.8	15.5	14.7	7.0	46.9	240	300	0.0237	44
1TZ9002-1DC2	160M			6	1170	86.0	75.0	30.5	17.7	16.7	5.9	70.2	220	290	0.0499	81
1TZ9002-1CA6	132M	11	15	2	3520	87.5	92.0	41.0	23.7	19.6	7.5	34.0	270	370	0.0220	53
1TZ9002-1DA2	160M			2	3525	87.5	86.0	38.0	22.0	21.0	6.0	34.2	200	280	0.0297	69
1TZ9002-1DB2	160M			4	1760	88.5	83.0	39.5	22.5	22.0	6.8	68.4	230	300	0.0440	62
1TZ9002-1DC4	160L			6	1165	89.0	77.0	42.0	24.3	20.1	6.3	103.3	190	270	0.0678	92
1TZ9002-1DA3	160M	15	20	2	3540	88.5	87.0	51.0	29.5	28.0	6.9	47.0	240	320	0.0360	77
1TZ9002-1DB4	160L			4	1760	89.5	84.0	52.0	30.5	28.5	8.0	94.0	290	360	0.0560	82
1TZ9502-1EC4	180L			6	1170	90.2	79.0	65.9	38.1	31.5	6.2	147	210	280	0.1700	155

IE1⁺ / 60Hz

Totally Enclosed Fan-Cooled type, IP55
Class F insulation, Class B temperature rise, continuous rating S1

Type	Model number	Output		P	Full load revolution speed rpm	Full load efficiency %	Full load power factor %	Full load current A			Starting current	Torsional moment			Moment of inertia Kgm2	Approximate weight IM B3 Kg		
		KW	HP					220V	380V	460V		Full load torsional moment NM	Starting torsional moment %	Maximum torsional moment %				
1TZ9002-1DA4	160L	18.5	25	2	3530	89.5	88.0	72.2	41.8	34.5	7.8	58.0	270	340	0.0440	78		
1TZ9502-1EB2	180M			4	1768	91.0	85.0	72.2	41.8	34.5	7.6	115	220	320	0.1300	170		
1TZ9502-1EC6	180L			6	1168	91.0	79.0	80.5	46.6	38.5	5.9	180	210	270	0.2100	165		
1TZ9502-2AC4	200L			6	1178	91.0	80.0	79.5	46.0	38.0	6.3	178	240	250	0.2500	200		
1TZ9002-1DA6	160L	22	30	2	3540	89.5	90.0	81.0	47.0	38.5	7.5	66	260	350	0.0490	85		
1TZ9502-1EA2	180M			2	3550	89.5	87.0	82.6	47.9	39.5	8.2	66	280	370	0.0690	150		
1TZ9502-1EB4	180L			4	1765	91.0	84.0	86.8	50.3	41.5	8.2	137	270	360	0.1300	170		
1TZ9502-2AC5	200L			6	1180	91.7	81.0	94.1	54.5	45.0	6.9	214	270	270	0.3000	220		
1TZ9502-1EA6	180L	30	40	2	3540	91.5	90.0	107	62.0	51.0	8.4	90	240	350	0.0900	180		
1TZ9502-2AA4	200L			2	3560	91.5	81.0	120	69.0	57.0	7.6	90	270	360	0.1240	195		
1TZ9502-1EB6	180L			4	1765	92.4	81.0	121	70.2	58.0	7.4	187	260	330	0.1600	185		
1TZ9502-2AB5	200L			4	1772	92.4	84.0	117	68.0	56.0	7.3	186	230	300	0.2000	220		
1TZ9502-2AC6	200L			6	1175	91.7	79.0	126	73.0	60.0	6.3	280	250	260	0.3800	245		
1TZ9502-2BC2	225M			6	1182	91.7	82.0	105	61.0	50.0	7.0	242	310	270	0.4900	275		
1TZ9502-2AA5	200L	37	50	2	3555	91.7	89.0	134	77.5	64	8.3	112	280	350	0.1500	230		
1TZ9502-2AB6	200L			4	1770	93.0	83.0	144	84	69	7.2	229	220	290	0.2500	240		
1TZ9502-2BB0	225S			4	1778	92.4	84.0	126	73	60	7.7	199	280	340	0.3700	260		
1TZ9502-2CC2	250M			6	1185	91.7	81.0	132	76.3	63	6.8	298	300	260	0.7600	355		
1TZ9502-2AA6	200L	45	60	2	3555	92.4	87.0	167	97	80	7.8	137	270	350	0.1800	245		
1TZ9502-2BA2	225M			2	3565	91.7	88.0	147	85	70	7.4	121	250	330	0.2200	280		
1TZ9502-2BB2	225M			4	1785	93.0	85.0	149	86	71	8.4	241	310	360	0.4500	295		
1TZ9502-2DC0	280S			6	1186	91.7	84.0	153	89	73	7.5	362	270	270	1.1000	465		
1TZ9502-2BA6	225M	55	75	2														
1TZ9502-2CA2	250M			2	3575	92.4	88.0	178	103	85	7.3	147	220	330	0.4000	360		
1TZ9502-2BB6	225M			4	1775	93.0	87.0				6.7	339	250	260	0.4900	320		
1TZ9502-2CB2	250M			4	1782	93.0	85.0	182	106	87	7.0	295	290	300	0.6900	375		
1TZ9502-2DC2	280M			6	1188	92.1	84.0	186	108	89	7.3	442	300	290	1.4000	500		
1TZ9502-2CA6	250M			75	100	2												
1TZ9502-2DA0	280S	2	3582			93.0	87.0	243	141	116	7.7	200	230	330	0.7200	490		
1TZ9502-2CB6	250M	4																
1TZ9502-2DB0	280S	4	1788			93.2	84.0	251	146	120	7.9	401	250	310	1.2000	520		
1TZ9502-2DC6	280M	6	1185			93.0	85.0	299	173	143	7.0	730	280	260	1.7000	560		
1TZ9502-3AC0	315S	6	1190			93.0	82.0	257	149	123	7.7	602	280	300	2.1000	670		
1TZ9502-2DA2	280M	90	125	2	3578	93.0	89.0	285	165	136	7.7	240	290	330	0.8300	530		
1TZ9502-2DB2	280M			4	1788	93.2	85.0	299	173	143	7.3	481	260	290	1.4000	570		
1TZ9502-3AC2	315S			6	1190	93.0	83.0	306	177	146	7.8	722	290	310	2.5000	740		
1TZ9502-2DA6	280M	110	150	2														
1TZ9502-3AA0	315S			2	3586	93.0	87.0	358	207	171	8.9	293	280	360	1.2000	710		
1TZ9502-2DB6	280M			4														
1TZ9502-3AB0	315S			4	1788	93.5	85.0	364	211	174	7.7	588	260	290	1.9400	720		
1TZ9502-3AC4	315L			6	1190	94.1	85.0	364	210	173	7.6	883	290	310	3.2000	880		
1TZ9502-3AA2	315M	132	175	2	3586	94.1	90.0	410	237	196	8.6	352	260	320	1.4000	770		
1TZ9502-3AB2	315M			4	1790	94.5	85.0	430	248	205	7.8	704	330	320	2.3100	860		
1TZ9502-3AC5	315M			6	1191	94.1	85.0	435	251	205	9.2	1058	350	340	4.0200	970		
1TZ9502-3AA4	315L	160	215	2	3586	94.1	89.0	502	291	240	9.1	426	280	360	1.6000	890		
1TZ9502-3AB4	315L			6	1192	94.1	84.0	533	309	255	9.6	1282	370	380	4.7100	1160		
1TZ9502-3AC6	315L			6	1192	94.1	84.0	533	309	255	9.6	1282	370	380	4.7100	1160		
1TZ9502-3AA5	315L	200	270	2	3588	94.1	91.0	617	357	295	8.4	532	290	320	2.1000	1010		
1TZ9502-3AB5	315L			4	1790	94.5	86.0	648	375	310	8.0	1067	300	310	3.4600	1110		

IE4 1TZ9004 Standard Motor Dimensional

B3

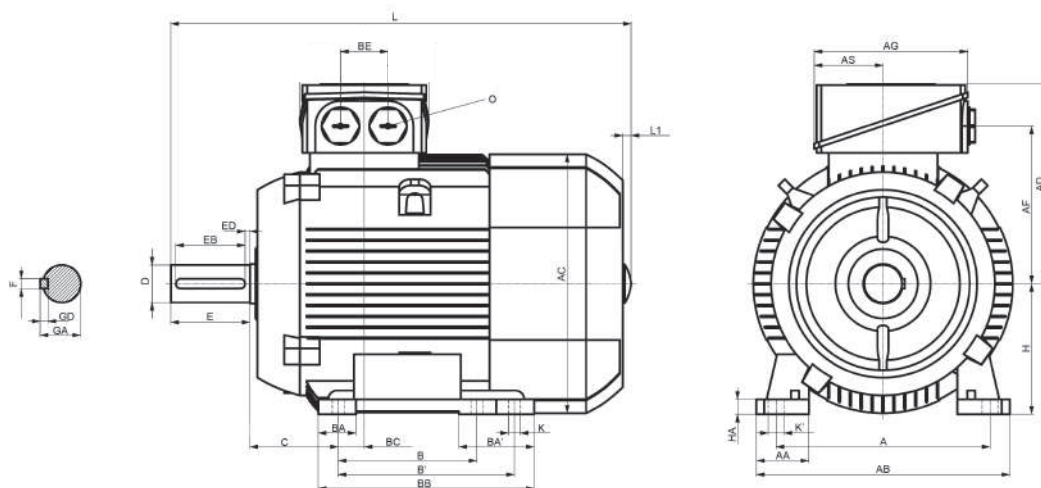

B5

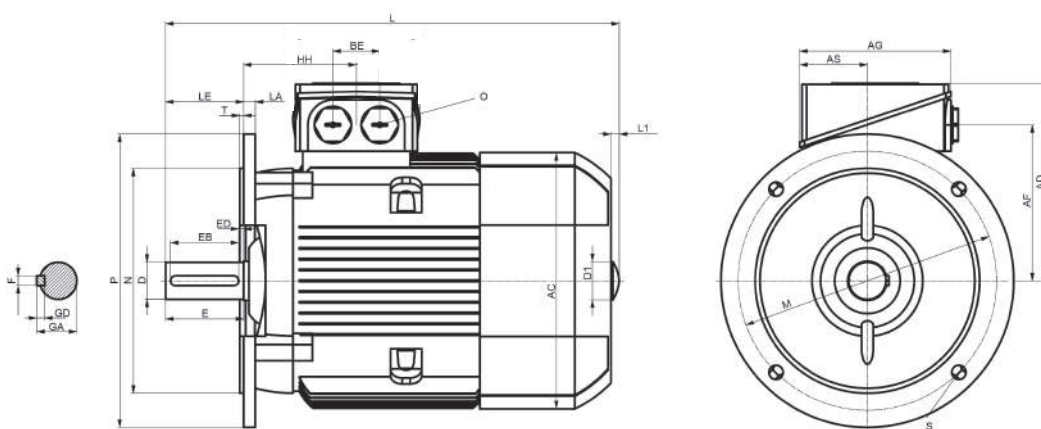

B3																																
Model Number	HP			A	AA	AB	AC	B	B'	BA	BA'	BB	C	H	HA	AD	AF	K	K'	L	AG	AS	O	BE	D	DB	E	F	GD	GA	BC	
	2P	4P	6P																													
100L	4	3		160	42	196	198	140	-	37.5	37.5	176	63	100	12	166	126	12	16	431	135	63.5	2MM32x1.5	50	28	M10x33.5	60	8	7	31	33.5	
		4																														481
112M	5.5			190	46	226	222	140	-	37.5	37.5	176	70	112	12	177	137	12	16	414	135	63.5	2MM32x1.5	50	28	M10x33.5	60	8	7	31	26	
		5.5																														464
132S	7.5			216	53	256	262	140	(178)	38	76	218	89	132	15	202	160	12	16	465	155	70.5	2MM40x1.5	48	38	M12x42	80	10	8	41	26.5	
	10	7.5																														515
132M		10						(140)	178																							
160M	15			254	60	300	314	210	(254)	44	89	300	108	160	18	237	190	15	19	604	175	77.5	2MM40x1.5	57	42	M16x49	110	12	8	45	47	
	20	15																														664
160L	25	20						(210)	254																							

B5											
Model Number	LE	D1	LA	M	N	P	S	T	ED	EB	HH
100L	60	32	11	215	180	250	14.5	4	5	50	96.5
112M	60	32	11	215	180	250	14.5	4	5	50	96
132S/M	80	39	12	265	230	300	14.5	4	5	70	116
160M/L	110	45	13	300	250	350	18.5	5	10	90	155

1TZ series bearing number		
Model Number	Shaft End	Non-Shaft End
100	6206ZZC3	6206ZZC3
112	6306ZZC3	6306ZZC3
132	6308ZZC3	6308ZZC3
160	6309ZZC3	6309ZZC3

- Frame size 132 and 160 with a fixed base provide two sets of locking holes, B and B'. Models without bases only provide one set without () hole.
- Model numbers 80 and 90 have only one outlet hole.
- Actual motor bearings should be subject to those printed on the plate.
- Shaft diameter (D) tolerance
 $\Phi D \leq \Phi 30:j6 / \Phi 31-\Phi 50:k6 / \Phi D > \Phi 50:m6$
- Shaft height (H) tolerance
 Model numbers below 250: +0.0-0.5/ Model numbers above 280: +0-1
- Shaft end tapping size DB according to DIN332
- Unit: mm

IE4 1TZ9504 Standard Motor Dimensional Drawing

B3

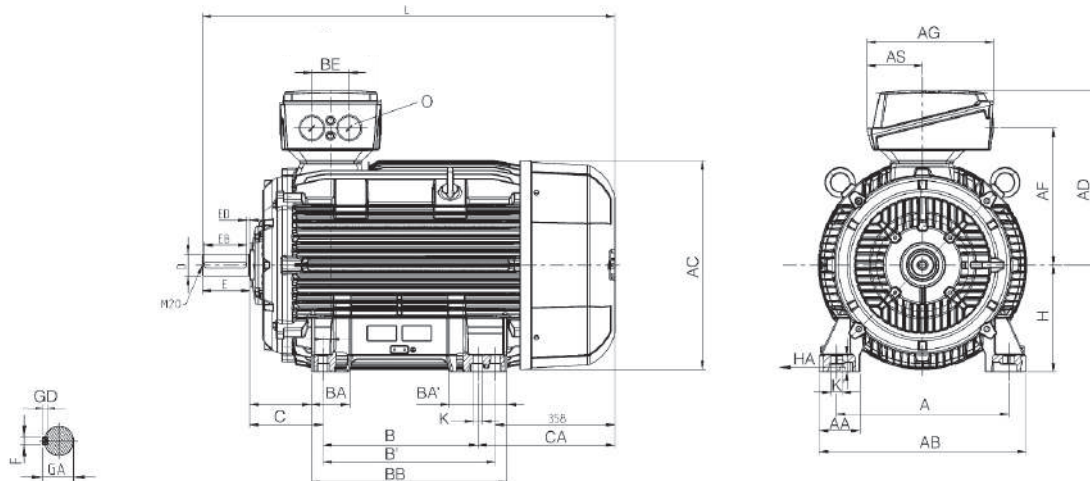

B5

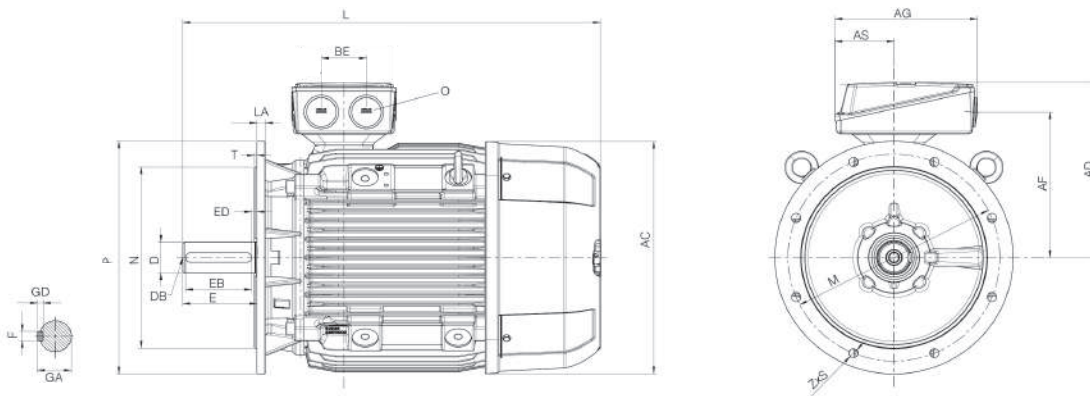

Model Number	HP				B3																													
	2P	4P	6P	8P	A	AA	AB	AC	B	B'	BA	BA'	BB	C	H	HA	AD	AF	K	K'	L	AG	AS	O	BE	D	DB	E	F	GD	GA	BC		
180M		25			279	65	339	356	241	279	85	120	328	121	180	20	286	234	15	19	668	189	92	2MM40x1.5	60	48	M16	110	14	9	51.5	34		
	30																				698												698	
180L		30																																
200L	40	40			318	70	378	396	305	-	104	104	355	133	200	25	315	259	19	25	746	265	112	2MM50x1.5	85	55	M20	110	16	10	59	31		
50								286		92	117	361	124	225	34	338	282	19	25	848	266	112			60			140	18	11	64			
225S		50			356	80	436	449	311														818			85	55	M20	110	16	10	59	15	
225M		60																			928			60				140	18	11	64			
250M	75				406	100	490	497	349	-	102	102	409	168	250	40	410	322	24	30	887	319	145	2MM63x1.5	110	60	M20	140	18	11	64	24		
	75																				957					65								
280S	100				457	100	540	551	368	-													2MM63x1.5	110	65				18	11	69			
	100														101	152	479	190	280	40	433	345			24	30	1070	319	145		75	M20	140	
280M	125								419	-													2MM63x1.5	110	65				18	11	69	20		
	125																										75	M20	140		20	12	79.5	
315S	150				508	120	610	616	406	-	113	170	527									1052		2MM63x1.5	110	65			140	18	8	69		
	175																														65			
315M		150							457	-	113	170	578									1217		2MM63x1.5	110	65			170	22	14	85		
		175																				1247						80				170	22	14
315L	215													216	315	50	515	404	28	35	1217	374	164	2MM63x1.5	110	65	M20	140	18	8	69	22		
	270								508													1372						65				140	18	8
		215																				1402				80			170	22	14	85		
		270																																

Model Number	HP				B5										
	2P	4P	6P	8P	LA	M	N	P	S	T	ED	EB	HH		
180	30	25	30		13	300	250	350	18.5	5	5	100	155		
200	40	40			15	350	300	400	18.5	5	5	100	164		
	50														
225	60				16	400	350	450	18.5	5		100	164		
		50									10	125			
250	75	75			18	500	450	550	18.5	5	10	125	192		
280	100	100			18	500	450	550	18.5	5	10	125	210		
	125	125													
315	150				22	600	550	660	24	8	10	125	238		
	175														
	215														
	270														
	150										25	140			

1TZ9504 series bearing number		
Model Number	Shaft End	Non-Shaft End
180	6310ZC3	6310ZC3
200	6312ZC3	6312ZC3
225	6313ZC3	6313ZC3
250	6315ZC3	6315ZC3
280-2P	6315C3	6315C3
280-4,6,8P	6317C3	6317C3
315-2P	6316C3	6316C3
315-4,6,8P	6319C3	6319C3

- Shaft diameter (D) tolerance
 $\Phi D \leq \Phi 30; j6 / \Phi 31 - \Phi 50; k6 / \Phi D > \Phi 50; m6$
- Shaft height (H) tolerance
 Model numbers below 250: ± 0.05 / Model numbers above 280: ± 0.1
- Shaft end tapping size DB according to DIN332
- Unit: mm

IE4 1TZ9004

Variable-frequency Motor Dimensional Drawing

B3

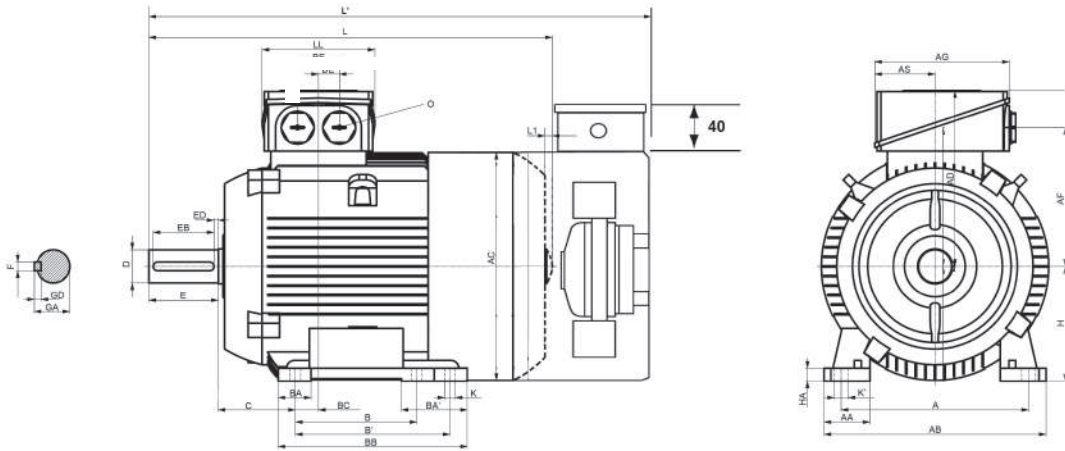

B5

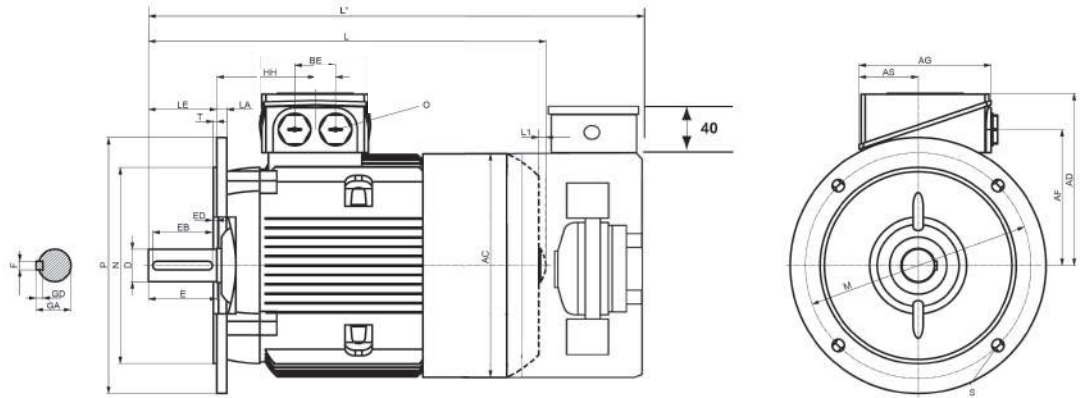

B3																																
Model Number	HP			A	AA	AB	AC	B	B'	BA	BA'	BB	C	H	HA	AD	AF	K	K'	L	L'	AG	AS	O	BE	D	DB	E	F	GD	GA	BC
	2P	4P	6P																													
100L	4	3		160	42	196	198	140	-	37.5	37.5	176	63	100	12	166	126	12	16	430.5	481	135	63.5	M10x33.5	50	28	60	8	7	31	33.5	
		4																		480.5	531											
112M	5.5			190	46	226	222	140	-	37.5	37.5	176	70	112	12	177	137	12	16	414	514	135	63.5	2xM32x1.5	50	28	60	8	7	31	26	
		5.5																		464	564											M12x42
132S	7.5			216	53	256	262	140	(178)	38	76	218	89	132	15	202	160	12	16	465	565	155	70.5	48	38	80	10	8	41	26.5		
	10	7.5	(140)					178	515											615												
132M	10																			604	704	175	77.5	57	42	110	12	8	45	47		
																				664	764										2xM40x1.5	M16x49
160M	15			254	60	300	314	210	(254)	44	89	300	108	160	18	237	190	15	19													
160L	25	20						(210)	254																							

B5											
Model Number	LE	D1	LA	M	N	P	S	T	ED	EB	HH
100L	60	32	11	215	180	250	14.5	4	5	50	96.5
112M	60	32	11	215	180	250	14.5	4	5	50	96
132S/M	80	39	12	265	230	300	14.5	4	5	70	115.5
160M/L	110	45	13	300	250	350	18.5	5	10	90	155

Variable-frequency motor specification

		Standard type		Optional type
		63~200	225~315	112~200
Independent fan	Model number	63~200	225~315	112~200
	Power supply	1Ø, 220V	3Ø, 380V	3Ø, 380V
Decoder	Maximum frequency	150KHz Max		150KHz Max
	Resolution	1024 pulse		200~2048 pulse
	Output form	Line driver		Line driver NPN NPN open collector Push pull
	Power supply	8~24VDC		5V / 8~24VDC
Overheat protector	Type	N.C guarded switch		3 x PTC

IE3 1TZ9003 Standard Motor Dimensional Drawing

B3

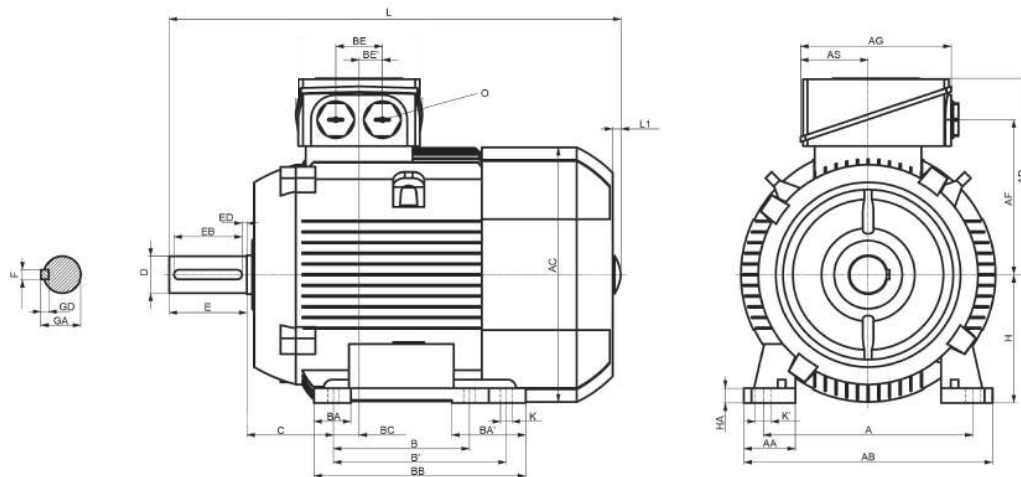

B5

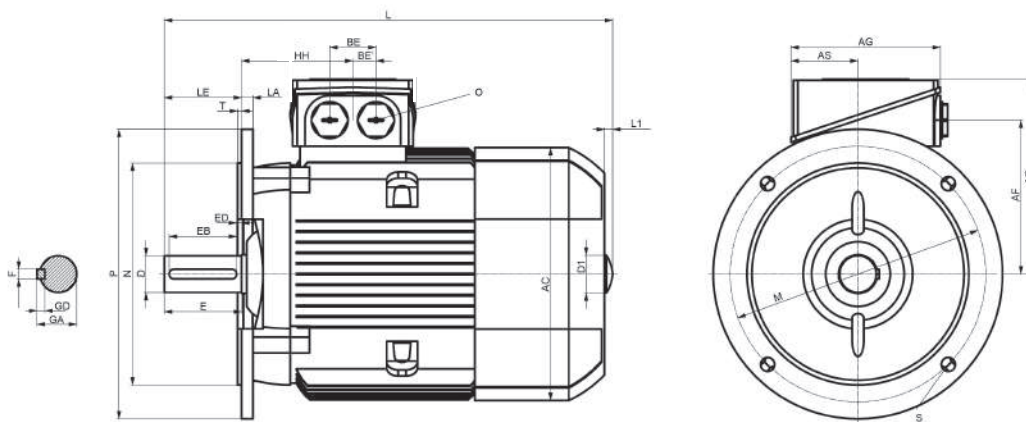

Model Number	HP				A	AA	AB	AC	B	B'	BA	BA'	BB	C	H	HA	AD	AF	K	K'	L	AG	AS	O	BE	BE'	D	DB	E	F	GD	GA	BC
	2P	4P	6P	8P																													
71M	-	1/3	1/4	-	112	30.5	132	145	90	-	32	32	106	45	71	7	149	112	7	7	240 280	126	62	M25x1.5 M16x1.5	36	18	14	M5	30	5	5	16	20.5
	-	1/2	1/3	-																													
80M	1	3/4	1/2	-	125	30.5	150	159	100	-	32	-	118	50	80	8	122	96.5	9.5	13.5	292 327	93	43	M25x1.5	-	18	19	M6	40	6	6	21.5	23
	1.5	1	3/4	-																													
90S	2	1.5	1	-	140	30.5	165	178	100	(125)	33	54	143	56	90	10	126	102	10	14	347 387	93	43	M25x1.5	-	18	24	M8	50	8	7	27	22.5
90L	3	2	1.5	-	140	30.5	165	178	100	(100)	125	54	143	56	90	10	126	102	10	14	347 387	93	43	M25x1.5	-	18	24	M8	50	8	7	27	22.5
100L	-	-	2 50Hz	-	160	42	196	198	140	-	37.5	37.5	176	63	100	12	166	126	12	16	396 431	135	63.5	M25x1.5	50	25	28	M10x3.5	60	8	7	31	33.5
	4	3	-	-																													
112M	5.5	7.5	2/60 Hz	-	190	46	226	222	140	-	37.5	37.5	176	70	112	12	177	137	12	16	414	135	63.5	M25x1.5	50	25	28	M10x3.5	60	8	7	31	26
	7.5	-	3/60 Hz	3					140	(178)			180 Base Detachable	89	132	15	202	160	12	16	465 515			M25x1.5	50	25	28	M10x3.5	60	8	7	31	26
132S	-	-	5.5	-	216	53	256	262	140	(178)	38	76 Base Fixed	218 Base Fixed	89	132	15	202	160	12	16	465 515	155	70.5	M25x1.5	48	24	38	M12x4	80	10	8	41	26.5
	15	10	7.5	4					140	(178)																							
132M	-	-	5.5	-	216	53	256	262	140	(178)	38	76 Base Fixed	218 Base Fixed	89	132	15	202	160	12	16	465 515	155	70.5	M25x1.5	48	24	38	M12x4	80	10	8	41	26.5
	15	10	7.5	4					140	(178)																							
160M	15	20	15	10	254	60	300	314	210	(254)	44	89	300	108	160	18	237	190	15	19	604 664	175	77.5	M25x1.5	57	28.5	42	M16x4	110	12	8	45	47
	25	20	15	10					210	(210)	254	89	300	108	160	18	237	190	15	19	604 664	175	77.5	M25x1.5	57	28.5	42	M16x4	110	12	8	45	47

Model Number	B5											
	LE	D1	LA	M	N	P	S	Z	T	ED	EB	HH
71M	30	-	5	130	110	160	10	4	3.5	4	22	65.5
80M	40	-	10	165	130	200	12	4	3.5	4	32	73
90L	50	-	10	165	130	200	12	4	3.5	5	40	78.5
100L	60	32	11	215	180	250	14.5	4	4	5	50	96.5
112M	60	32	11	215	180	250	14.5	4	4	5	50	96
132S/M	80	39	12	265	230	300	14.5	4	4	5	70	115.5
160M/L	110	45	13	300	250	350	18.5	4	5	10	90	155

Frame size	1TZ series bearing number		
	Bracket	Shaft end	Non-shaft end
71	Aluminum & Iron	6202ZC3	6202ZC3
80	Aluminum	6004ZC3	6004ZC3
	Iron	6204ZC3	6204ZC3
90	Aluminum	6205ZC3	6004ZC3
	Iron	6205ZC3	6204ZC3
100	Aluminum & Iron	6206ZC3	6206ZC3
112	Iron	6306ZC3	6306ZC3
132	Iron	6308ZC3	6308ZC3
160	Iron	6309ZC3	6309ZC3

- Shaft diameter (D) tolerance
 $\Phi D \leq \Phi 30:j6 / \Phi 31 - \Phi 50:k6 / \Phi D > \Phi 50:m6$
- Shaft height (H) tolerance
 Frame size below 250: +0.-0.5/
 Frame size above 280: +0-1
- Shaft end tapping size DB according to DIN332
- Unit: mm

IE3 1TZ9503 Standard Motor Dimensional Drawing

B3

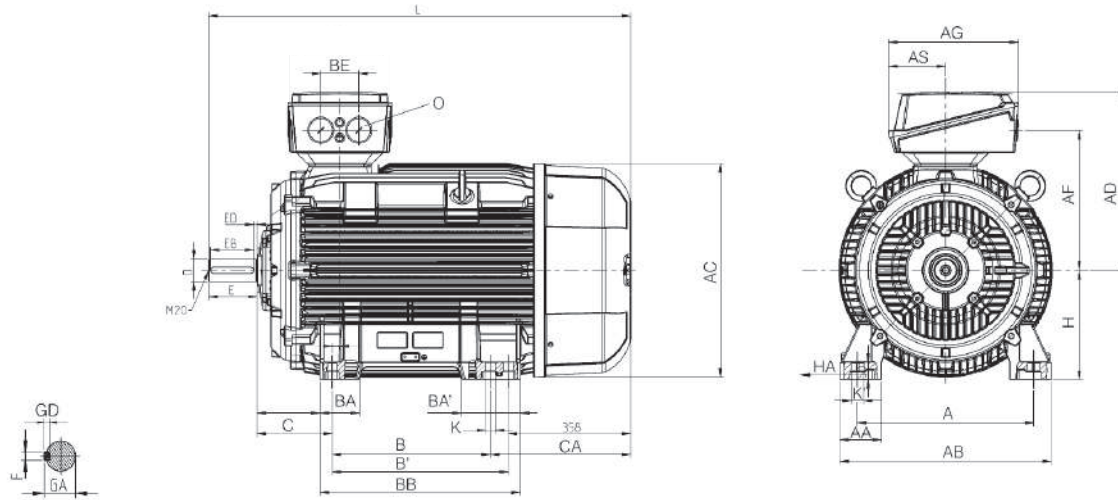

B5

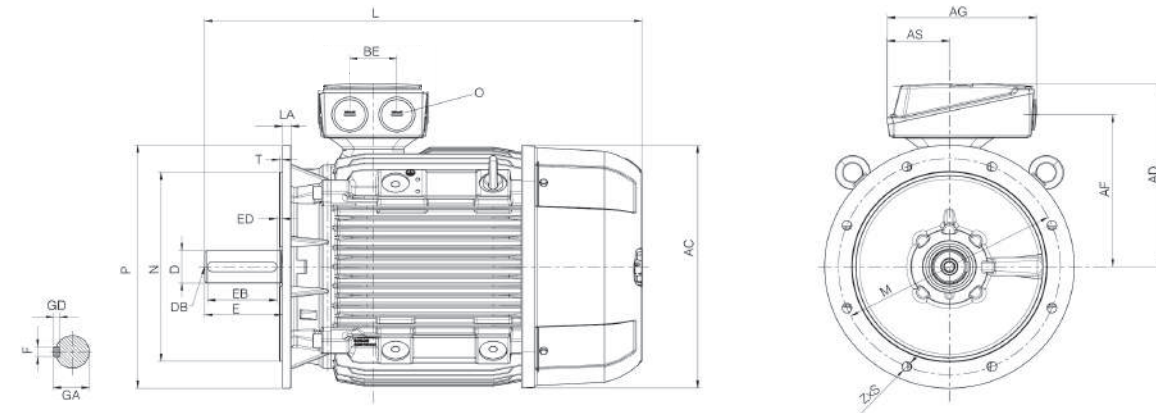

Model Number	HP				B3																														
	2P	4P	6P	8P	A	AA	AB	AC	B	B'	BA	BA'	BB	C	H	HA	AD	AF	K	K'	L	AG	AS	O	BE	D	DB	E	F	GD	GA	ED	EB	BC	
180 M	30	25			279	65	339	356	241	(279)	85	120 (固定)	328	121	180	20	286	234	15	19	668	190	92	2M40L5	60	48	M16	110	14	9	51.5	5	100	34	
	40	30	20						(241)	279											721														746
180L	40	30	25	15	318	70	378	396	305	-	104	104	355	133	200	25	315	259	19	25	721	266	112	2M50L5	85	55	M20	110	16	10	59	5	100	31	
	50	40	30	20					286	(311)											788														818
200L	40	30	25	15	318	70	378	396	305	-	104	104	355	133	200	25	315	259	19	25	721	266	112	2M50L5	85	55	M20	110	16	10	59	5	100	31	
	50	40	30	20					286	(311)											788														818
225S	60	50			356	80	436	449	286	(311)	92	117	361	149	225	34	338	282	19	25	788	266	112	2M50L5	85	55	M20	110	16	10	59	5	100	31	
	75	60	40	30					(286)	311											898														928
225M	60	50			356	80	436	449	286	(311)	92	117	361	149	225	34	338	282	19	25	788	266	112	2M50L5	85	55	M20	110	16	10	59	5	100	31	
	75	60	40	30					(286)	311											898														928
250M	75	50	40		406	100	490	497	349	-	102	102	409	168	250	40	410	322	24	30	887	319	145	2M63L5	110	65	M20	140	18	11	69	10	125	24	
	100	75	50	40					368	(419)											960														1082
280S	100	60	50		457	100	540	551	368	(419)	101	152	479	190	280	40	433	345	24	30	960	319	145	2M63L5	110	75	M20	140	18	11	69	10	125	20	
	100	60	50	60					(368)	419											1070														1082
280M	125	100	60	50	457	100	540	551	368	(419)	101	152	479	190	280	40	433	345	24	30	960	319	145	2M63L5	110	75	M20	140	18	11	69	10	125	20	
	150	100	60	50					(368)	419											1070														1082
315S	150	100	60	50	457	100	540	551	368	(419)	101	152	479	190	280	40	433	345	24	30	960	319	145	2M63L5	110	75	M20	140	18	11	69	10	125	20	
	175	100	60	50					(368)	419											1070														1082
315M	175	100	60	50	457	100	540	551	368	(419)	101	152	479	190	280	40	433	345	24	30	960	319	145	2M63L5	110	75	M20	140	18	11	69	10	125	20	
	215	100	60	50					(368)	419											1070														1082
315L	215	100	60	50	457	100	540	551	368	(419)	101	152	479	190	280	40	433	345	24	30	960	319	145	2M63L5	110	75	M20	140	18	11	69	10	125	20	
	270	100	60	50					(368)	419											1070														1082

Model Number	B5												
	2P	4P	6P	8P	LE	LA	M	N	P	S	Z	T	HH
180	30	25	20	15	110	13	300	250	350	18.5	4	5	155
	40	30	25	20									
200	40	30	25	20	110	15	350	300	400	18.5	4	5	164
	50	40	30	25									
225	60	50			110	16	400	350	450	18.5	8	5	164
	75	60	40	30									
250	75	60	40	30	140	18	500	450	550	18.5	8	5	192
	100	75	60	40									
280	100	75	60	50	140	18	500	450	550	18.5	8	5	210
	125	100	75	60									
315	150	100	60	50	140	22	600	550	660	24	8	6	238
	175	125	100	75									

1TZ9503 series bearing number		
Model Number	Shaft End	Non-Shaft End
180	6310ZC3	6310ZC3
200	6312ZC3	6312ZC3
225	6313ZC3	6313ZC3
250	6315ZC3	6315ZC3
280-2P	6315C3	6315C3
280-4,6,8P	6317C3	6317C3
315-2P	6316C3	6316C3
315-4,6,8P	6319C3	6319C3

- Shaft diameter (D) tolerance
 $\Phi D \leq \Phi 30:j6 / \Phi 31 - \Phi 50:k6 / \Phi D > \Phi 50:m6$
- Shaft height (H) tolerance
 Frame size below 250: +0.-0.5/ Model numbers above 280: +0-1
- Shaft end tapping size DB according to DIN332
- Unit: mm

IE3 1TZ9003 Variable-frequency Motor Dimensional Drawing

B3

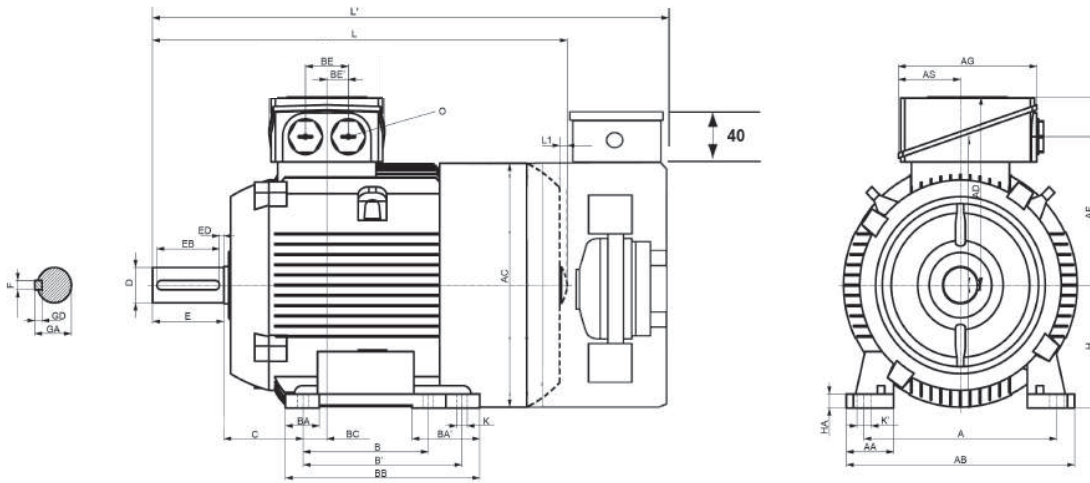

B5

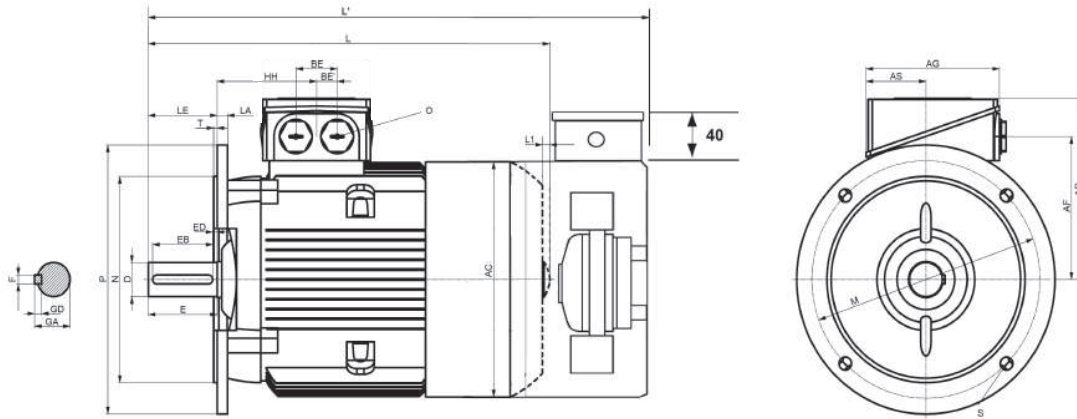

Model Number	HP				B3																														
	2P	4P	6P	8P	A	AA	AB	AC	B	B'	BA	BA'	BB	C	H	HA	AD	AF	K	K'	L	L'	AG	AS	O	BE	BE'	D	DB	E	F	GD	GA	BC	
71M	-	1/3	1/4	-	112	30.5	132	145	90	-	32	32	106	45	71	7	149	112	7	7	240	290	126	62	M25x1.5 M16x1.5	36	18	14	M5	30	5	5	16	20.5	
	-	1/2	1/3	-																	280	330													
80M	1	3/4	1/2	-	125	30.5	150	159	100	-	32	-	118	50	80	8	122	96.5	9.5	13.5	292	342	93	43	M25x1.5	-	18	19	M6	40	6	6	21.5	23	
	1.5	1	3/4	-																	327	377													
90S	2	1.5	1	-	140	30.5	165	178	100	125	33	54	143	56	90	10	126	102	10	14	347	397	93	43	M25x1.5	-	18	24	M8	50	8	7	27	22.5	
90L	3	2	1.5	-																	387	437													
100L	-	-	2	50Hz	-	160	42	196	198	140	-	37.5	37.5	176	63	100	12	166	126	12	16	396	446	135	63.5	M25x1.5	50	25	28	M10x3.5	60	8	7	31	33.5
	4	3	4	-																		431	481												
112M	5.5	7.5	2/60Hz	3/50Hz	-	190	46	226	222	140	-	37.5	37.5	176	70	112	12	177	137	12	16	414	514	135	63.5	M25x1.5	50	25	28	M10x3.5	60	8	7	31	26
	7.5	-	3/60Hz	4																		465	565												
132S	10	7.5	-	-						140	(178)											465	565	155	70.5	M25x1.5	48	24	38	M12x2	80	10	8	41	26.5
	-	-	5.5	-	216	53	256	262					38	76	218	89	132	15	202	160	12	16	465												
132M	15	10	7.5	4						(140)	178											515	615	155	70.5	M25x1.5	48	24	38	M12x2	80	10	8	41	26.5
	-	15	-	-																		515	615												
160M	15	20	15	10	5.5	7.5				210	(254)	44	89	300	108	160	18	237	190	15	19	604	704	175	77.5	M25x1.5	57	28.5	42	M16x49	110	12	8	45	47
160L	25	20	25	15	10					(210)	254											664	764												

Model Number	B5											
	LE	D1	LA	M	N	P	S	Z	T	ED	EB	HH
71M	30	-	5	130	110	160	10	4	3.5	4	22	65.5
80M	40	-	10	165	130	200	12	4	3.5	4	32	73
90L	50	-	10	165	130	200	12	4	3.5	5	40	78.5
100L	60	32	11	215	180	250	14.5	4	4	5	50	96.5
112M	60	32	11	215	180	250	14.5	4	4	5	50	96
132S/M	80	39	12	265	230	300	14.5	4	4	5	70	116
160M/L	110	45	13	300	250	350	18.5	4	5	10	90	155

Variable-frequency motor specification

Independent fan	Standard type		Optional type	
	Model number	63~200	225~315	112~200
Decoder	Power supply	1Ø, 220V	3Ø, 380V	3Ø, 380V
	Maximum frequency	150KHz Max		150KHz Max
Decoder	Resolution	1024 pulse		200~2048 pulse
	Output form	Line driver		Line driver NPN NPN open collector Push pull
Overheat protector	Power supply	8~24VDC		5V / 8~24VDC
Overheat protector	Type	N.C guarded switch		3 x PTC

IE3 1TZ9503

Variable-frequency Motor Dimensional Drawing

B3

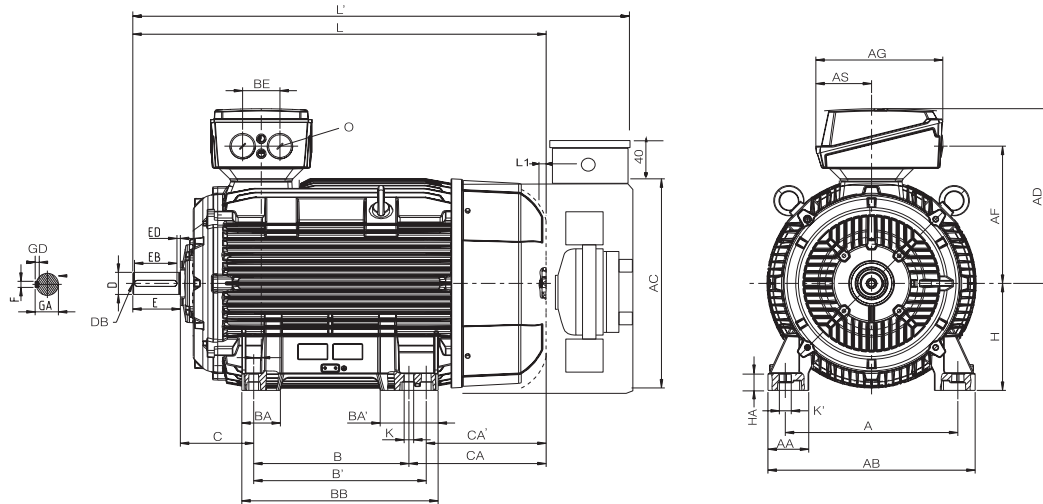

B5

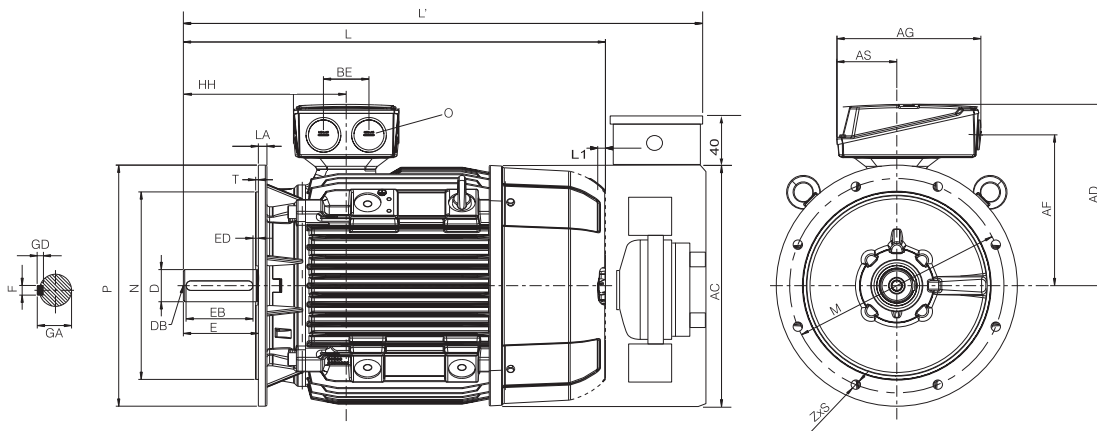

Model Number	HP				A	AA	AB	AC	B	B'	BA	BA'	BB	C	H	HA	AD	AF	K	K'	L	L'	AG	AS	O	BE	D	DB	E	F	GD	GA	ED	EB	BC
	2P	4P	6P	8P																															
180M	30	25			279	65	339	356	241	(279)	85	120	328	121	180	20	286	234	15	19	668	828	190	92	2M40xL5	60	48	M16	110	14	9	51.5	5	100	34
	40	30	20	25					15	(241)											279	668													
180L	40	30	20	25	318	70	378	396	305	-	104	104	355	133	200	25	315	258.5	19	25	721	881	266	112	2M40xL5	85	55	M20	110	16	10	59	5	100	31
	40	40	30	25					20	305											-	746													
200L	50	40	30	20	356	80	436	449	286	(311)	92	117	361	149	225	34	338	282	19	25	887	1047	266	112	2M40xL5	85	55	M20	110	16	10	59	5	100	15
	50	50	40	30					20	(286)											311	898													
225S	60	50	40	25	406	100	490	497	349	-	102	102	409	168	250	40	410	322	24	30	957	1117	319	145	2M40xL5	110	60	M20	140	18	11	64	10	125	24
	60	75	50	40					25	349											-	928													
225M	75	60	40	30	457	100	540	551	368	(419)	101	152	479	190	280	40	433	345	24	30	960	1290	319	145	2M40xL5	110	65	M20	140	18	11	69	10	125	20
	75	75	50	40					30	(368)											419	928													
250M	100	100	60	50	508	120	610	616	406	(457)	113	170	527	216	315	50	515	404	28	35	1052	1382	374	164	2M40xL5	110	65	M20	140	18	11	69	10	125	22
	100	100	60	50					40	406											(457)	1082													
280S	125	100	75	60	508	120	610	616	457	(508)	113	170	578	216	315	50	515	404	28	35	1217	1547	374	164	2M40xL5	110	65	M20	140	18	11	69	10	125	22
	125	100	75	60					40	457											(508)	1247													
280M	150	125	100	75	508	120	610	616	406	(457)	113	170	578	216	315	50	515	404	28	35	1217	1547	374	164	2M40xL5	110	65	M20	140	18	11	69	10	125	22
	150	125	100	75					40	406											(457)	1247													
315S	175	150	125	100	508	120	610	616	457	(508)	113	170	578	216	315	50	515	404	28	35	1217	1547	374	164	2M40xL5	110	65	M20	140	18	11	69	10	125	22
	175	150	125	100					40	457											(508)	1247													
315M	215	175	150	125	508	120	610	616	406	(457)	113	170	578	216	315	50	515	404	28	35	1217	1547	374	164	2M40xL5	110	65	M20	140	18	11	69	10	125	22
	215	175	150	125					40	406											(457)	1247													
315L	270	215	175	150	508	120	610	616	457	(508)	113	170	578	216	315	50	515	404	28	35	1217	1547	374	164	2M40xL5	110	65	M20	140	18	11	69	10	125	22
	270	215	175	150					40	406											(457)	1247													
315	150	125	100	75	508	120	610	616	406	(457)	113	170	578	216	315	50	515	404	28	35	1217	1547	374	164	2M40xL5	110	65	M20	140	18	11	69	10	125	22
	150	125	100	75					40	406											(457)	1247													
315	175	150	125	100	508	120	610	616	457	(508)	113	170	578	216	315	50	515	404	28	35	1217	1547	374	164	2M40xL5	110	65	M20	140	18	11	69	10	125	22
	175	150	125	100					40	406											(457)	1247													
315	215	175	150	125	508	120	610	616	457	(508)	113	170	578	216	315	50	515	404	28	35	1217	1547	374	164	2M40xL5	110	65	M20	140	18	11	69	10	125	22
	215	175	150	125					40	406											(457)	1247													
315	270	215	175	150	508	120	610	616	457	(508)	113	170	578	216	315	50	515	404	28	35	1217	1547	374	164	2M40xL5	110	65	M20	140	18	11	69	10	125	22
	270	215	175	150					40	406											(457)	1247													

Model Number	B5												
	2P	4P	6P	8P	LE	LA	M	N	P	S	Z	T	HH
180	30	25	20	15	110	13	300	250	350	18.5	4	5	155
	40	30	25	15	110	13	300	250	350	18.5	4	5	155
200	40	30	25	20	110	15	350	300	400	18.5	4	5	164
	50	40	30	20	110	15	350	300	400	18.5	4	5	164
225	60	50	40	25	110	16	400	350	450	18.5	8	5	164
	75	60	50	25	140	16	400	350	450	18.5	8	5	164
250	75	60	50	30	140	18	500	450	550	18.5	8	5	192
	100	75	60	30	140	18	500	450	550	18.5	8	5	192
280	100	75	60	40	140	18	500	450	550	18.5	8	5	210
	125	100	75	40	140	18	500	450	550	18.5	8	5	210
315	150	125	100	50	140	22	600	550	660	24	8	6	238
	175	150	125	50	170	22	600	550	660	24	8	6	238

Variable-frequency motor specification

	Standard type		Optional type	
	Model number	63~200	225~315	112~200
Independent fan	Power supply	1 Ø, 220V	3 Ø, 380V	3 Ø, 380V
	Maximum frequency	150KHz Max	150KHz Max	150KHz Max
Decoder	Resolution	1024 pulse	1024 pulse	200~2048 pulse
	Output form	Line driver	Line driver	Line driver NPN open collector Push pull
Overheat protector	Power supply	8~24VDC	8~24VDC	5V / 8~24VDC
	Type	N.C guarded switch	N.C guarded switch	3 x PTC

IE1 1TZ9002 Standard Motor Dimensional Drawing

B3

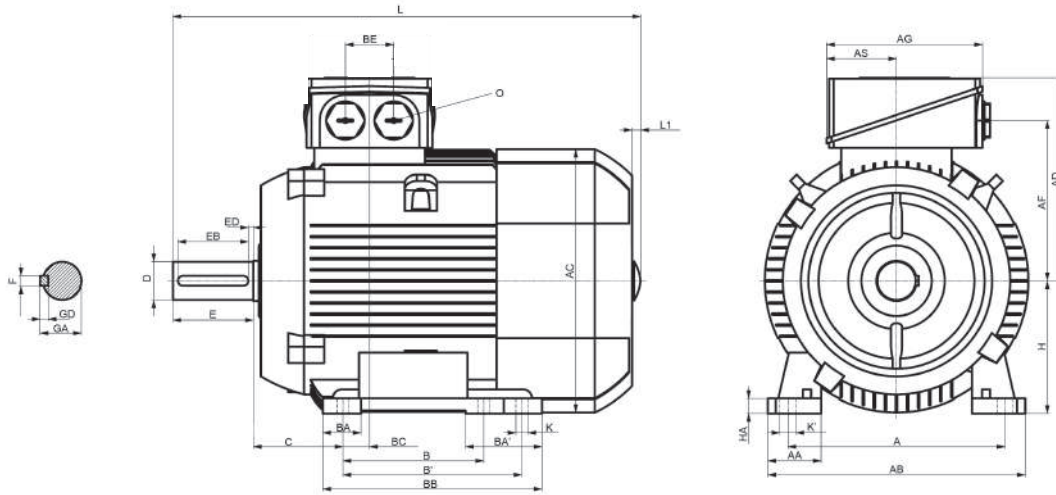

B5

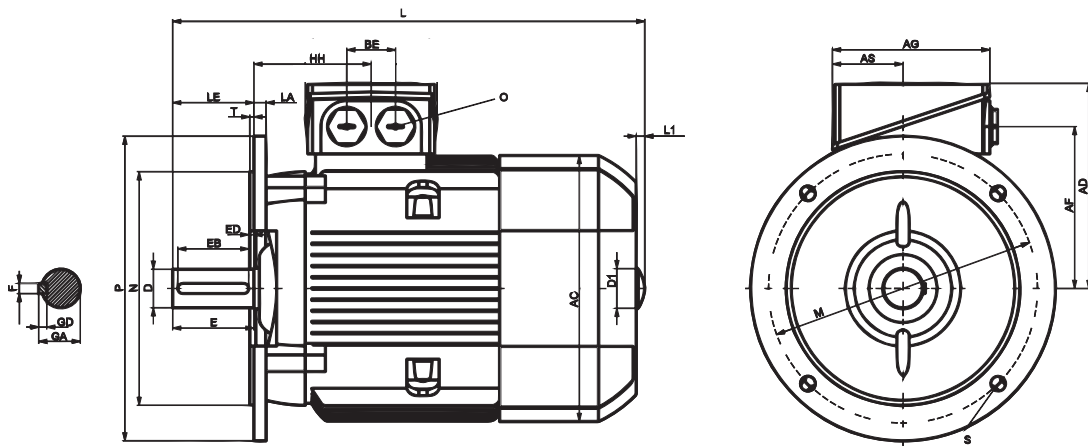

Model Number	HP				B3																	O	BE	D	DB	E	F	GD	GA	BC		
	2P	4P	6P	8P	A	AA	AB	AC	B	B'	BA	BA'	BB	C	H	HA	AD	AF	K	K'	L										AG	AS
63M	1/4 1/3	1/4	-	-	100	27	120	118	80	-	28	-	96	40	63	7	101	77.5	7	10	202.5	75	37	M25x1.5 M16x1.5	32	11	M4	23	4	4	12.5	30
71M	1/2 3/4	1/3 1/2	1/4 1/3	-	112	30.5	132	139	90	-	27	-	106	45	71	7	111	87.5	7	10	240	75	37	M25x1.5 M16x1.5	32	14	M5*12.5	30	5	5	16	18
80M	1 2	3/4 1	1/2 3/4	1/4 1/3	125	30.5	150	159	100	-	32	-	118	50	80	8	121.5	96.5	9.5	13.5	292	93	43	M25x1.5 M16x1.5	36	19	M6*16	40	6	6	21.5	23
90S/L	2 3	2	1	1/2 3/4	140	30.5	165	178	100	125	33	54	143	56	90	10	126	101.5	10	14	347	93	43	M25x1.5 M16x1.5	36	24	M8*19	50	8	7	27	22.5
100L	4	3 4	2	1 1.5	160	42	196	198	140	-	37.5	37.5	176	63	100	12	166	125.5	12	16	395.5	135	63.5	M25x1.5 M16x1.5	50	28	M10x33.5	60	8	7	31	33.5
112M	5.5 7.5	5.5 7.5	2 3 4	2	190	46	226	222	140	-	37.5	37.5	176	70	112	12	177	136.5	12	16	389 414	135	63.5	M25x1.5 M16x1.5	50	28	M10x33.5	60	8	7	31	26
132S	7.5 10	7.5	3.4 5.5	3	216	53	256	262	140 (178)	-	38	76	218	89	132	15	202	159.5	12	16	465	155	70.5	M25x1.5 M16x1.5	48	38	M12x42	80	10	8	41	26.5
132M	- 15	10 -	7.5 -	4 -	216	53	256	262	140 (140)	178	38	76	218	89	132	15	202	159.5	12	16	515	155	70.5	M25x1.5 M16x1.5	48	38	M12x42	80	10	8	41	26.5
160M	15 20	15	10	5.5 7.5	254	60	300	314	210 (254)	-	44	89	300	108	160	18	236.5	190	15	19	604	175	77.5	M25x1.5 M16x1.5	57	42	M16x49	110	12	8	45	47
160L	25	20	15	10	254	60	300	314	210 (210)	254	44	89	300	108	160	18	236.5	190	15	19	604	175	77.5	M25x1.5 M16x1.5	57	42	M16x49	110	12	8	45	47

Model Number	B5										
	LE	D1	LA	M	N	P	S	T	ED	EB	HH
63M	23	-	8	115	95	140	10	3	3.5	16	69.5
71M	30	-	9	130	110	160	10	3.5	4	22	69.5
80M	40	-	10	165	130	200	12	3.5	4	32	73
90L	50	-	10	165	130	200	12	3.5	5	40	78.5
100L	60	32	11	215	180	250	14.5	4	5	50	96.5
112M	60	32	11	215	180	250	14.5	4	5	50	96
132S/M	80	39	12	265	230	300	14.5	4	5	70	116
160M/L	110	45	13	300	250	350	18.5	5	10	90	155

1TZ series bearing number		
Frame size	Shaft end	Non-shaft end
63	6201ZZC3	6201ZZC3
71	6202ZZC3	6202ZZC3
80	6204ZZC3*	6004ZZC3
90	6205ZZC3	6004ZZC3
100	6206ZZC3	6206ZZC3
112	6306ZZC3	6306ZZC3
132	6308ZZC3	6308ZZC3
160	6309ZZC3	6309ZZC3

- 1TZ 80M aluminum bracket shaft end
 - 1TZ 80M iron bracket shaft end bearing: 6204ZZC3
 - Frame size 90, 132, and 160 fixed bases only provide two sets of locking holes B and B'.
 - Shaft diameter (D) tolerance
 $\Phi D \leq \Phi 30:j6 / \Phi 31-\Phi 50:k6 / \Phi D > \Phi 50:m6$
 - Shaft height (H) tolerance.
 - Frame size below 250: +0.-0.5/ Model numbers above 280: +0-1
 - Shaft end tapping size DB according to DIN332
- Unit: mm

IE1 1TZ9002

Variable-frequency Motor Dimensional Drawing

B3

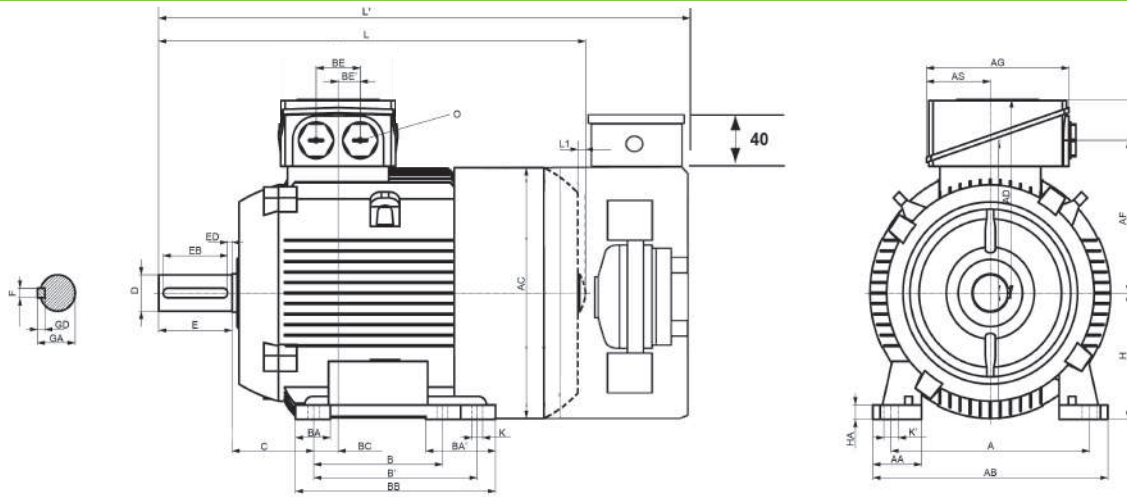

B5

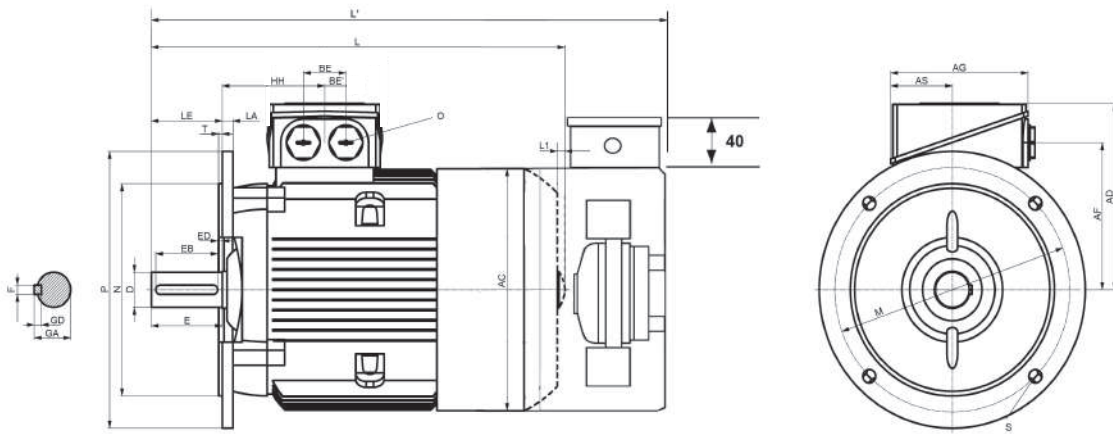

Model Number	HP				B3																O	BE	D	DB	E	F	GD	GA	BC			
	2P	4P	6P	8P	A	AA	AB	AC	B	B'	BA	BA'	BB	C	H	HA	AD	AF	K	K'										L	AG	AS
63M	1/4	1/4	-	-	100	27	120	118	80	-	28	-	96	40	63	7	101	77.5	7	10	203	75	37	M25x1.5 M16x1.5	32	11	M4	23	4	4	12.5	30
71M	1/2	1/3	1/4	-	112	30.5	132	139	90	-	27	-	106	45	71	7	111	87.5	7	10	240	75	37		32	14	M5*12.5	30	5	5	16	18
80M	1	3/4	1/2	1/4	125	30.5	150	159	100	-	32	-	118	50	80	8	122	96.5	9.5	13.5	292	93	43	M25x1.5 M16x1.5	36	19	M6*16	40	6	6	21.5	23
90S/L	2	2	1	1/2	140	30.5	165	178	100	125	33	54	143	56	90	10	126	102	10	14	347	93	43		36	24	M8*19	50	8	7	27	22.5
100L	4	3	2	1	160	42	196	198	140	-	37.5	37.5	176	63	100	12	166	126	12	16	396	135	63.5	2xM32x1.5	50	28	M10x33.5	60	8	7	31	33.5
112M	5.5	5.5	2	2	190	46	226	222	140	-	37.5	37.5	176	70	112	12	177	137	12	16	389	135	63.5		50	28		M10x33.5	60	8	7	31
132S	7.5	7.5	3	3	216	53	256	262	140	(178)	38	76	218	89	132	15	202	160	12	16	465	155	70.5	2xM32x1.5	48	38	M12x42	80	10	8	41	26.5
132M	-	10	7.5	4					(140)	178																						
160M	15	15	10	5.5	254	60	300	314	(210)	254	44	89	300	108	160	18	237	190	15	19	604	175	77.5	2xM40x1.5	57	42	M16x49	110	12	8	45	47
	20	15	10	7.5																												

Model Number	B5										
	LE	D1	LA	M	N	P	S	T	ED	EB	HH
63M	23	-	8	115	95	140	10	3	3.5	16	69.5
71M	30	-	9	130	110	160	10	3.5	4	22	69.5
80M	40	-	10	165	130	200	12	3.5	4	32	73
90L	50	-	10	165	130	200	12	3.5	5	40	78.5
100L	60	32	11	215	180	250	14.5	4	5	50	96.5
112M	60	32	11	215	180	250	14.5	4	5	50	96
132S/M	80	39	12	265	230	300	14.5	4	5	70	116
160M/L	110	45	13	300	250	350	18.5	5	10	90	155

Variable-frequency motor specification

		Standard type		Optional type
		63~200	225~315	112~200
Independent fan	Model number	63~200	225~315	112~200
	Power supply	1Ø, 220V	3Ø, 380V	3Ø, 380V
Decoder	Maximum frequency	150KHz Max		150KHz Max
	Resolution	1024 pulse		200~2048 pulse
	Output form	Line driver		Line driver NPN NPN open collector Push pull
	Power supply	8~24VDC		5V / 8~24VDC
Overheat protector	Type	N.C guarded switch		3 x PTC

IE1 1TZ9502 Variable-frequency Motor Dimensional Drawing

B3

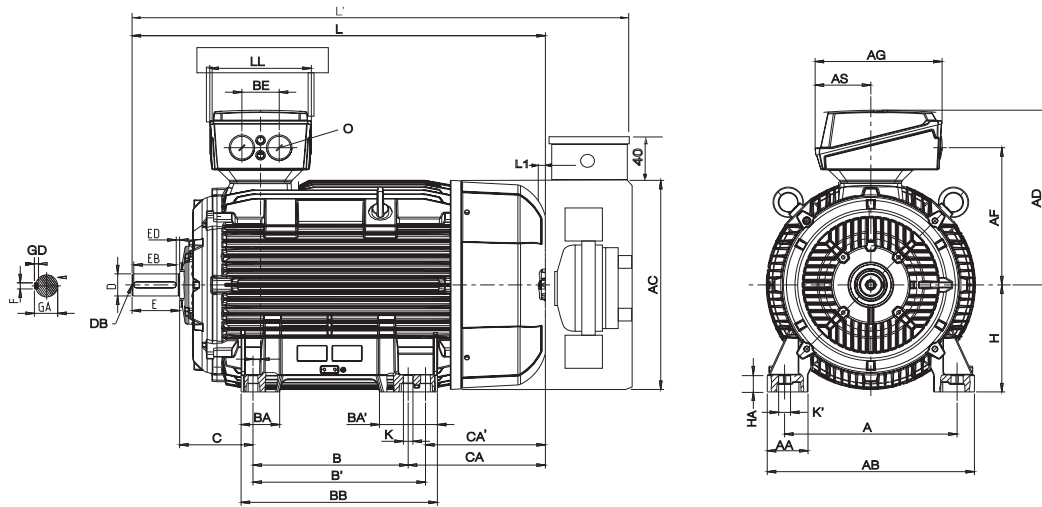

B5

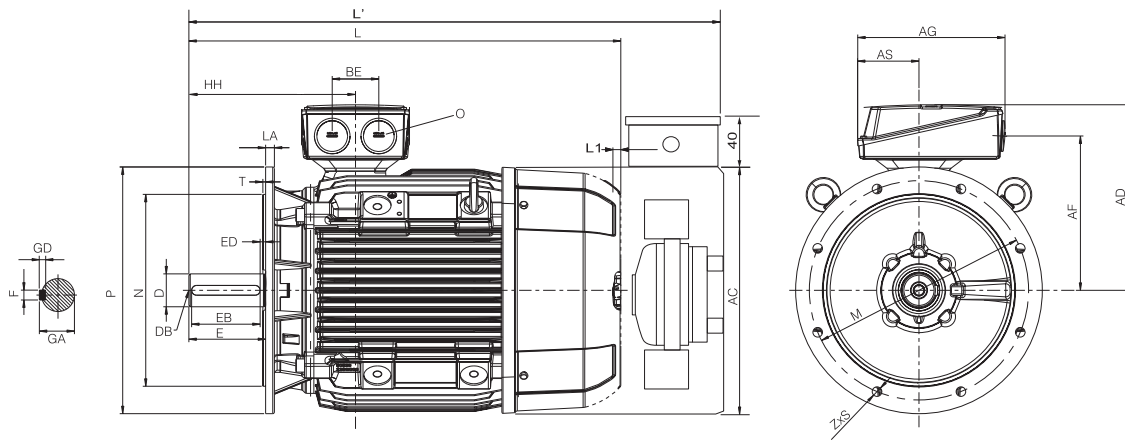

Model Number	HP				B3																	O	BE	D	DB	E	F	GD	GA	BC				
	2P	4P	6P	8P	A	AA	AB	AC	B	B'	BA	BA'	BB	C	H	HA	AD	AF	K	K'	L										L'	AG	AS	
180M 180L	30				279	65	339	356	241	279	85	120	328	120.5	180	20	286	234	15	19	668	828	189	91	20M40x1.5	60	48	M16	110	14	9	51.5	34	
	40	25	20	15																	698	858												
	40	30	25	20																														
200L	40	40	25	20	318	70	300	396	305	-	104	104	355	133	200	25	315	258.5	19	25	721	881	265	112	20M50x1.5	85	55	M20	110	16	10	59	31	
	50	30	20	25																	746	906												
	60	50	40	25																														
225S	60				356	80	436	449	286	311	92	117	361	149	225	34	338	282	19	25	758	998	266	112	20M50x1.5	85	55	M20	110	16	10	59	15	
	75	60	40	30																	788	1028												
	75	75	50	40																	818	1058												
225M	75				406	100	490	497	349	-	102	102	409	168	250	40	410	322	24	30	848	1088	319	145	20M63x1.5	110	65	M20	140	18	11	64	24	
	75	50	40	50																	887	1047												
	100																				957	1117												
250M	100				457	100	540	551	368	419	101	152	479	190	280	40	433	345	24	30	960	1290	319	145	20M63x1.5	110	75	M20	140	20	12	79.5	20	
	125	60	50	75																	1070	1400												
	150																																	
280S 280M	150				508	120	610	616	406	457	113	170	527	216	315	50	515	404	28	35	1052	1382	374	164	20M63x1.5	110	65	M20	140	18	11	69	22	
	175	100	60	100																	1082	1412												
	215	150	100	125																	1217	1547												
315SM	150				508	120	610	616	406	457	113	170	527	216	315	50	515	404	28	35	1247	1577	374	164	20M63x1.5	110	65	M20	140	18	11	69	22	
	175	100	60	100																	1402	1732												
	215	150	100	125																														
315L	215				508	120	610	616	406	457	113	170	527	216	315	50	515	404	28	35	1247	1577	374	164	20M63x1.5	110	65	M20	140	18	11	69	22	
	270																				176	227												648
	270	215																																

Model Number	B5													ED	EB	HH
	2P	4P	6P	8P	LA	M	N	P	S	Z	T					
180	30	25	20	15	13	300	250	350	18.5	4	5	5	100	155		
	40	30	25	20												
	40	40	30	25												
200	40	40	25	20	15	350	300	400	18.5	4	5	5	100	164		
	50	30	20	25												
	60	50	40	25												
225	60	-	-	-	16	400	350	450	18.5	8	5	5	100	164		
	75	50	40	30												
	75	60	50	30												
250	75	75	50	40	18	500	450	550	18.5	8	5	10	125	192		
	100	100	60	50												
	125	125	75	60												
280	100	100	60	50	18	500	450	550	18.5	8	5	10	125	210		
	125	125	75	60												
	150	150	100	75												
315	150				22	600	550	660	24	8	6	10	125	238		
	175															
	215															
	270															
	150	100	75												25	140
	175	125	100													
215	150	125														
270	175	150														

1TZ 9501 series bearing number		
Frame size	Shaft end	Non-shaft end
180	6310ZC3	6310ZC3
200	6312ZC3	6312ZC3
225	6313ZC3	6313ZC3
250	6315ZC3	6315ZC3
280-2P	6315C3	6315C3
280-4,6,8P	6317C3	6317C3
315-2P	6316C3	6316C3
315-4,6,8P	6319C3	6319C3

- Shaft diameter (D) tolerance
 $\Phi D \leq \Phi 30:j6 / \Phi 31 - \Phi 50:k6 / \Phi D > \Phi 50:m6$
- Shaft height (H) tolerance.
- Frame size below 250: +0.-0.5/ Model numbers above 280: +0-1
- Shaft end tapping size DB according to DIN332
Unit: mm

B14 Flange data ITZ series

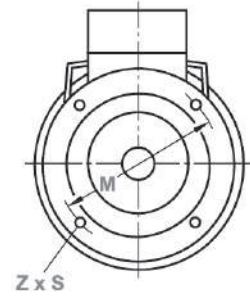
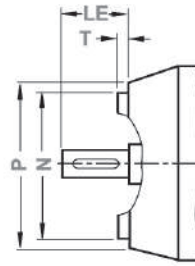
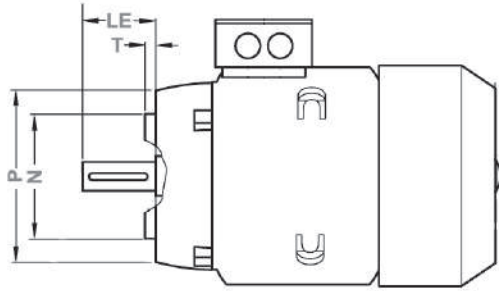

B14A								
Frame size	Flange dimension	M	N	P	LE	S	T	Z
63	FT75	75	60	90	23	M5	2.5	4
71	FT85	85	70	105	30	M6	2.5	4
80	FT100	100	80	120	40	M6	3	4
90	FT115	115	95	140	50	M8	3	4
100	FT130	130	110	160	60	M8	3.5	4
112	FT130	130	110	160	60	M8	3.5	4
132	FT165	165	130	200	80	M10	3.5	4
160	FT215	215	180	250	110	M12	4	4

B14B								
Flange dimension	M	N	P	LE	S	T	Z	
FT100	100	80	120	23	M6	3	4	
FT115	115	95	140	30	M8	3	4	
FT130	130	110	160	40	M8	3.5	4	
FT130	130	110	160	50	M8	3.5	4	
FT165	165	130	200	60	M10	3.5	4	
FT165	165	130	200	60	M10	3.5	4	
FT215	215	180	250	80	M12	4	4	

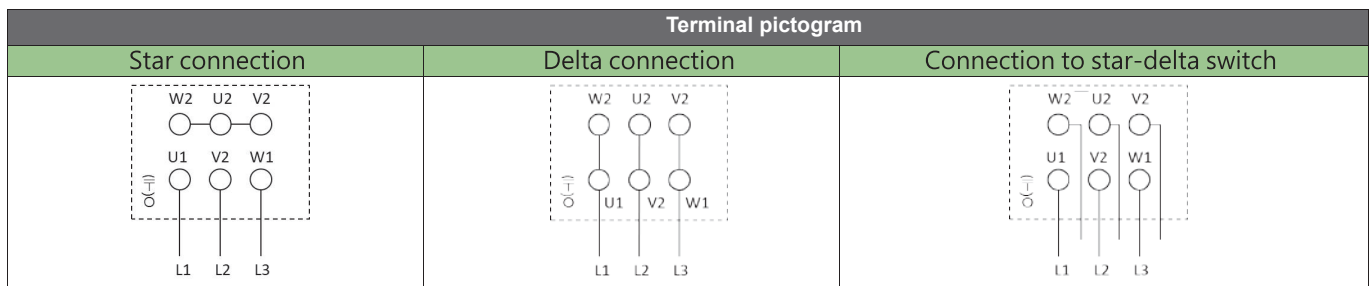

<p>Nine Fine IE3 H CE</p> <p>Made in Czech Rep.</p> <p>3-MOT 1T290031BB290AA4 UD 1401/1591549-002-001</p> <p>IEC/EN 60034 112M IMB3 IP55</p> <p>34kg Th.Cl. 155(F) -20°C ≤TAMB≤40°C</p> <p>Bearing: DE 6306-2ZC3, NE 6306-2ZC3</p> <table border="1" style="width: 100%;"> <thead> <tr> <th>V</th> <th>Hz</th> <th>A</th> <th>kW</th> <th>cos φ</th> <th>NOM.EFF</th> <th>1/min</th> <th>IE-CL</th> </tr> </thead> <tbody> <tr> <td>220 Δ</td> <td>60</td> <td>14.5</td> <td>4.0</td> <td>0.81</td> <td>89.5</td> <td>1765</td> <td>IE3</td> </tr> <tr> <td>380 Y</td> <td>60</td> <td>8.4</td> <td>4.0</td> <td>0.81</td> <td>89.5</td> <td>1765</td> <td>IE3</td> </tr> </tbody> </table>	V	Hz	A	kW	cos φ	NOM.EFF	1/min	IE-CL	220 Δ	60	14.5	4.0	0.81	89.5	1765	IE3	380 Y	60	8.4	4.0	0.81	89.5	1765	IE3	<p>Nine Fine IE4 H CE</p> <p>Made in Czech Rep.</p> <p>3-MOT 1CV4317B 1T256043AB734AA3-Z UC 1808/299999901</p> <p>IEC/EN 60034 315L IMB3 1560kg Th.Cl. 155(F) -20°C ≤TAMB≤40°C</p> <p>IP55</p> <p>IC411 6319-C4 6319-C4 40g 6000h 40g UNIFEX-N3 SF 1.15</p> <table border="1" style="width: 100%;"> <thead> <tr> <th>V</th> <th>Hz</th> <th>A</th> <th>kW</th> <th>cos φ</th> <th>NOM.EFF</th> <th>1/min</th> <th>IE-CL</th> </tr> </thead> <tbody> <tr> <td>400 Δ</td> <td>50</td> <td>570</td> <td>315</td> <td>0.83</td> <td>96.7</td> <td>1490</td> <td>IE4</td> </tr> <tr> <td>690 Y</td> <td>50</td> <td>330</td> <td>315</td> <td>0.83</td> <td>96.7</td> <td>1490</td> <td>IE4</td> </tr> <tr> <td>460 Δ</td> <td>60</td> <td>490</td> <td>315</td> <td>0.83</td> <td>96.8</td> <td>1790</td> <td>IE4</td> </tr> <tr> <td>460 Δ</td> <td>60</td> <td>560</td> <td>360</td> <td>0.84</td> <td>96.2</td> <td>1790</td> <td>IE3</td> </tr> </tbody> </table> <p style="text-align: center;">Made in Czech Rep.</p>	V	Hz	A	kW	cos φ	NOM.EFF	1/min	IE-CL	400 Δ	50	570	315	0.83	96.7	1490	IE4	690 Y	50	330	315	0.83	96.7	1490	IE4	460 Δ	60	490	315	0.83	96.8	1790	IE4	460 Δ	60	560	360	0.84	96.2	1790	IE3
V	Hz	A	kW	cos φ	NOM.EFF	1/min	IE-CL																																																										
220 Δ	60	14.5	4.0	0.81	89.5	1765	IE3																																																										
380 Y	60	8.4	4.0	0.81	89.5	1765	IE3																																																										
V	Hz	A	kW	cos φ	NOM.EFF	1/min	IE-CL																																																										
400 Δ	50	570	315	0.83	96.7	1490	IE4																																																										
690 Y	50	330	315	0.83	96.7	1490	IE4																																																										
460 Δ	60	490	315	0.83	96.8	1790	IE4																																																										
460 Δ	60	560	360	0.84	96.2	1790	IE3																																																										

Motor specifications sheet

Item	Standard specifications	Item	Standard specifications
Type	IE1/IE3/IE4 squirrel-cage high-efficiency induction motor	Power supply	Voltage regulation: within $\pm 5\%$, according to EN60034-1
Design basis	International Electrotechnical Commission (IEC), EU (EN60034-30:2008), Deutsches Institut für Normung (DIN).	Place	Interior or exterior
Voltage	Rated voltage	Ambient temperature	-20°C to + 40°C
Frequency	Rated frequency 50Hz or 60Hz	Humidity	Relative humidity 95%/25°C
Frame size	63 - 160L (cast aluminium), 180 - 355L (iron)	Height mark	Altitude under 1000 meter above sea level
Stator insulation	Full series Class F insulation 155°C	Drive method	Pulley or coupling
Temperature rise	Class B allowable range of temperature rise 80°C.	Steering	Reversible
Protected type	Fully enclosed external fan type (IP55), dustproof, waterproof, according to EN 60034-5	Starting method	full voltage starting or Y- Δ starting
Cooling method	Totally Enclosed (IC411)	Bearing	For frame size 280 or above: greased filled type, ball bearings, or roller bearings. For frame size below 280: pre-greased, ball bearings
	Fan-Cooled		
Delivered horsepower		Outlet box	Cast waterproof junction box with wire inlet hole, above the frame if viewed from the load end
Synchronous revolution speed		Outlet line	Six outlet lines with terminal block
Time rated	Continuous rated S1	Screw thread	ISO-M metric dimension
Installation method	IMB3 IMB5	Test procedure	According to IEC34 of the International Electrotechnical Commission, full voltage starting testing
	IMB14, IMB35, IMB34		

Load ratio efficiency / Power factor meter

Load ratio efficiency				
1/4 (load ratio)	1/2	3/4	4/4	5/4
93	96	97	97	96.5
92	95	96	96	95.5
90	93.5	95	95	94.5
89	92.5	94	94	93.5
88	91.5	93	93	92.5
87	91	92	92	91.5
86	90	91	91	90
85	89	90	90	89
84	88	89	89	88
80	87	88	88	87
79	86	87	87	86
78	85	86	86	85
76	84	85	85	83.5
74	83	84	84	82.5
72	82	83	83	81.5
70	81	82	82	80.5
68	80	81	81	79.5
66	79	80	80	78.5
64	77	79.5	79	77.5
62	75.5	78.5	78	76.5
60	74	77.5	77	75
58	73	76	76	74
56	72	75	75	73
55	71	74	74	72
54	70	73	73	71
53	68	72	72	70
52	67	71	71	69
51	66	70	70	68
50	65	69	69	67
49	64	67.5	68	66
48	62	66.5	67	65
47	61	65	66	64
46	60	64	65	63

Power factor				
1/4 (load ratio)	1/2	3/4	4/4	5/4
0.70	0.86	0.90	0.92	0.92
0.65	0.85	0.89	0.91	0.91
0.63	0.83	0.88	0.90	0.90
0.61	0.80	0.86	0.89	0.89
0.57	0.78	0.85	0.88	0.88
0.53	0.76	0.84	0.87	0.87
0.51	0.75	0.83	0.86	0.86
0.49	0.73	0.81	0.85	0.86
0.47	0.71	0.80	0.84	0.85
0.45	0.69	0.79	0.83	0.84
0.43	0.67	0.77	0.82	0.83
0.41	0.66	0.76	0.81	0.82
0.40	0.65	0.75	0.80	0.81
0.38	0.63	0.74	0.79	0.80
0.36	0.61	0.72	0.78	0.80
0.34	0.59	0.71	0.77	0.79
0.32	0.58	0.70	0.76	0.78
0.30	0.56	0.69	0.75	0.78
0.29	0.55	0.68	0.74	0.77
0.28	0.54	0.67	0.73	0.77
0.27	0.52	0.63	0.72	0.76
0.26	0.50	0.62	0.71	0.76



CUTES CORPORATION

NO.2-22, Nan Yuan Road, Chung Li City (320), Taoyuan, Taiwan, R.O.C.

TEL : +886-3-4526161

FAX : +886-3-4526227 · 886-3-4511347

E-mail:sales@cutes.com.tw



 **cutes**